

# EA304AH

(コントローラー付半田ごて)



電源	AC100V・50/60Hz
消費電力	ステーション：140W 半田付け：70W
設定温度	200~450°C
温度精度	設定温度から±10°C
サイズ	120(W)×190(D)×120(H)
重量	2.7Kg

※こて先別売り(EA304AG-1~-56)

- 強力な熱回復特性
- オートパワーシャットオフ機能
- 一台で、半田付け・半田除去・SMDリワークまで可能な画期的なステーション
- 簡単な温度補正 - フロントパネル左側にある温度補正穴(プロセスゲート)にこて先を差し込むだけで、自動的に正確なこて先設定温度に補正。
- 鉛フリー半田付け対応品
- 静電気対策仕様

## ◆別売りこて先◆

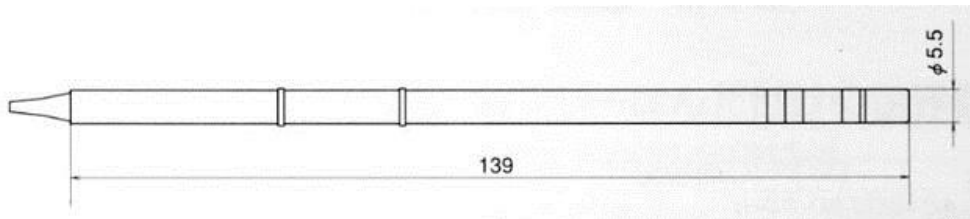

— : 廃番商品

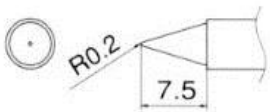

EA304AG-1

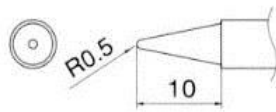

EA304AG-2

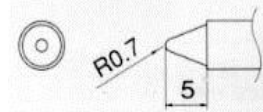

EA304AG-3

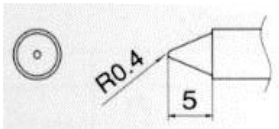

~~EA304AG-4~~

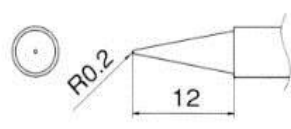

EA304AG-5

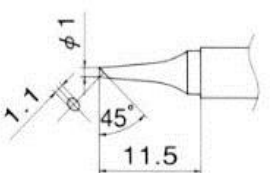

EA304AG-6

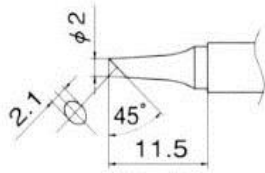

EA304AG-7

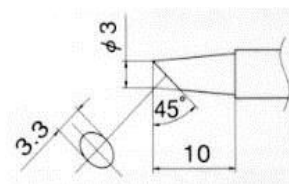

EA304AG-8

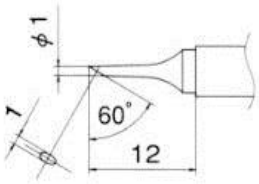

EA304AG-9

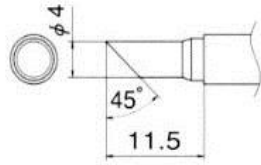

EA304AG-10

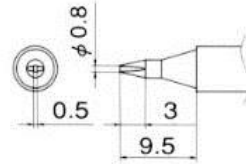

~~EA304AG-11~~

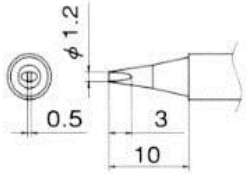

EA304AG-12

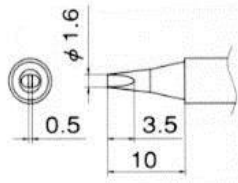

~~EA304AG-13~~

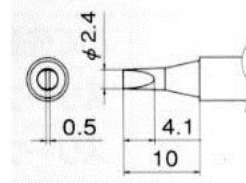

EA304AG-14

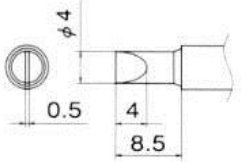

EA304AG-15

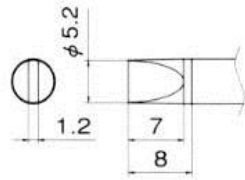

~~EA304AG-16~~

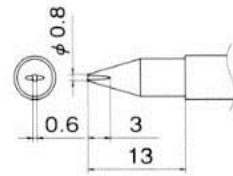

~~EA304AG-17~~

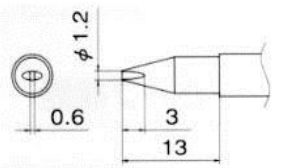

~~EA304AG-18~~

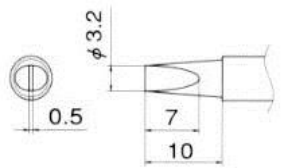

EA304AG-19

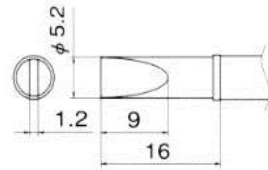

EA304AG-20

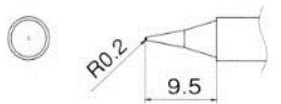

EA304AG-21

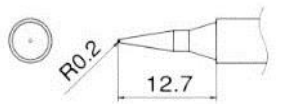

EA304AG-22

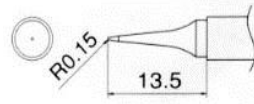

EA304AG-23

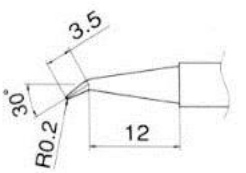

~~EA304AG-24~~

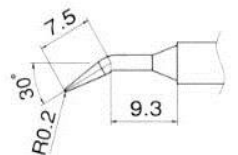

~~EA304AG-25~~

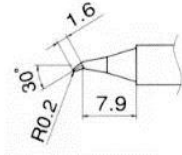

~~EA304AG-26~~

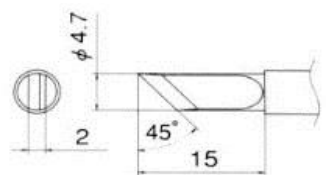

EA304AG-27

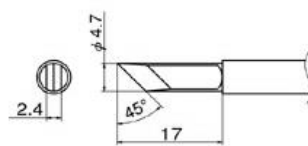

EA307AG-28

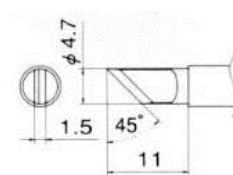

~~EA304AG-29~~

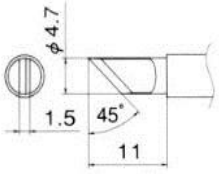

~~EA304AG-30~~

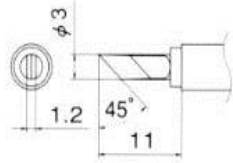

EA304AG-31

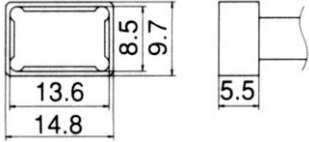

~~EA304AG-32~~

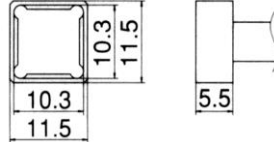

~~EA304AG-33~~

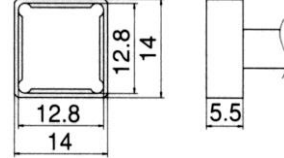

~~EA304AG-34~~

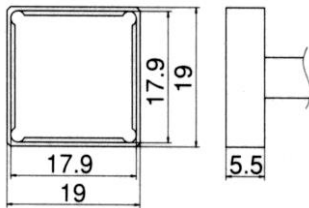

~~EA304AG-35~~

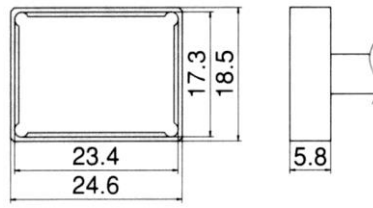

~~EA304AG-36~~

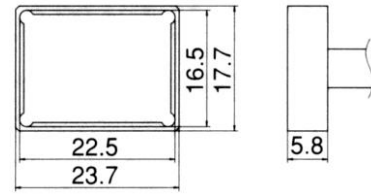

~~EA304AG-37~~

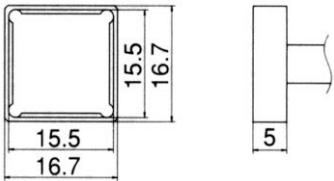

EA304AG-38

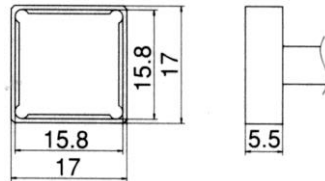

~~EA304AG-39~~

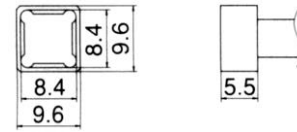

~~EA304AG-40~~

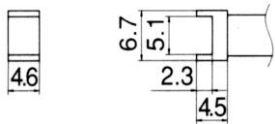

~~EA304AG-41~~

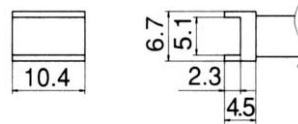

~~EA304AG-42~~

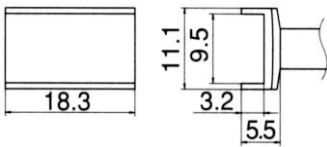

~~EA304AG-43~~

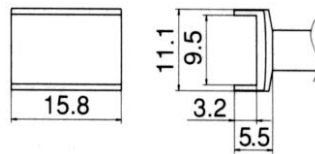

~~EA304AG-44~~

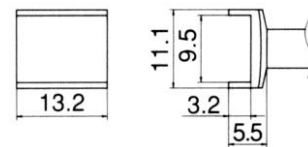

~~EA304AG-45~~

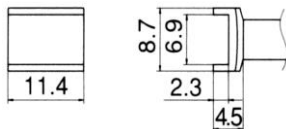

~~EA304AG-46~~

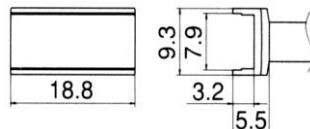

~~EA304AG-47~~

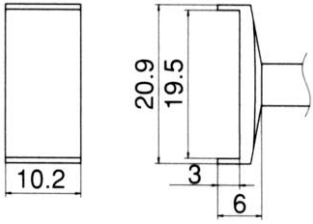

~~EA304AG-48~~

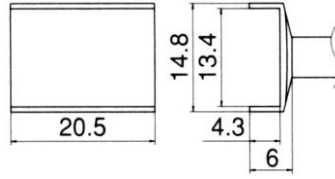

~~EA304AG-49~~

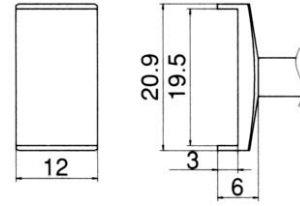

~~EA304AG-50~~

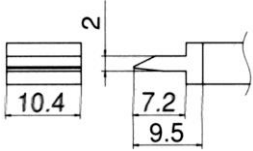

~~EA304AG-51~~

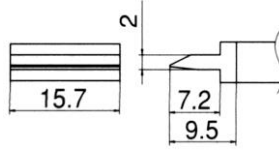

~~EA304AG-52~~

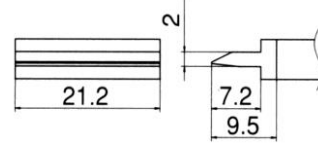

~~EA304AG-53~~

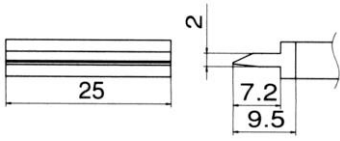

~~EA304AG-54~~

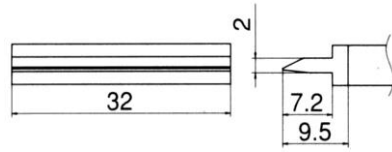

~~EA304AG-55~~

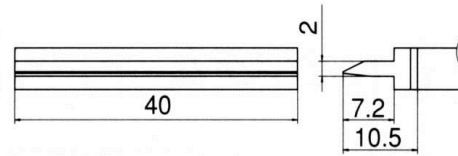

~~EA304AG-56~~