

240030

REPLACEMENT PARTS LIST

1	053383	WELDMENT: DOLLY (D5)	1
2	055248	CASTER: SET 3" SI W/ ZINC RIG	1

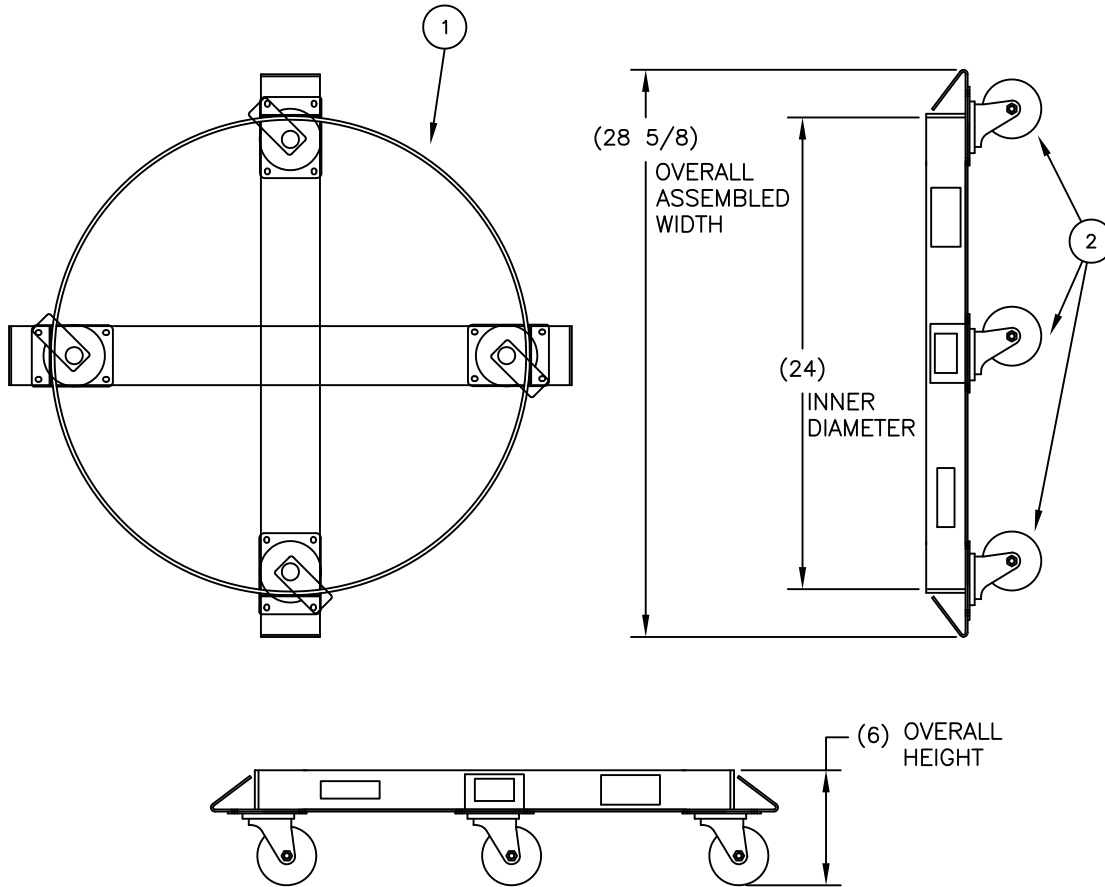

STEEL DRUM DOLLIES

- Superior design places drum chime over caster kingpin for greater load stability and long cater life.
- All welded steel frame construction with reinforced outriggers.
- Four bolt on 3" swivel casters.
- I.D. varies among models.
- Model available for 30, 55, and 85 gallon drums.

P/N 240030

Model: D5-SI  
 Capacity: 1,000 lbs  
 Weight: 24.5 lbs  
 Unit I.D: 24"  
 Drum size: 55 gal.  
 Caster Type: Sintered Iron  
 Box: Yes

THIS DRAWING IN ALL PARTICULARS IS WESCO INDUSTRIAL PRODUCTS INC. PROPERTY. ALL RIGHTS OF DESIGN, INVENTION OR USE OF ARE RESERVED.

PRINT ISSUED  
 NOV. 15, 2006  
 WESCO MANUFACTURING  
 ENGINEERING DEPARTMENT

R	W	S	APP
11-08-12	UPDATED PARTS LIST		
B	REV.	ECN & DATE	REVISIONS

WESCO INDUSTRIAL PRODUCTS INC.

NORTH WALES

PENNA. 19454

PART NAME		D5-SI		DRAWN:	
		DRUM DOLLIES		CHECKED:	
		TOLERANCE UNLESS OTHERWISE SPECIFIED		APP. ENGR.	
FRACTION	3 PLACE DECIMAL	2 PLACE DECIMAL	SCALE: 1" = 8"		
± 1/64	± .005	± .01	A-240030 REV B		
ANGULAR ± 1-1/2"	SHEET 1	OF 1			
BREAK ALL SHARP EDGES AND REMOVE ALL BURRS					