

## Effect on Nutsert

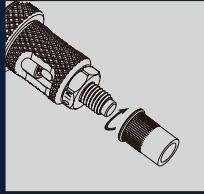

1. Screw nutsert onto mandrel

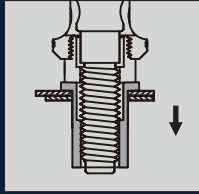

2. Place the nutsert in a pre-drilled hole

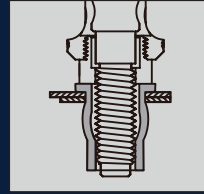

3. Nutsert starts to deform as handles are closed

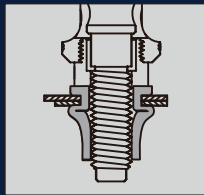

4. Nutsert is set and has a tight grip on the hole sides and the rear of the work

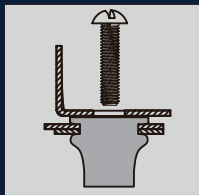

5. The work can be fastened

## Quality Guarantee

This product is guaranteed against defective materials and workmanship.

Your statutory rights are not affected.

**Spear & Jackson UK Ltd.**

Atlas Way, Atlas North  
Sheffield S4 7QQ, England

[www.eclipse-tools.co.uk](http://www.eclipse-tools.co.uk)

email: [sales@eclipse-tools.com](mailto:sales@eclipse-tools.com)

OVER 100 YEARS  
OF EXPERTISE



**ECLIPSE**  
PROFESSIONAL TOOLS



2746C-HD Compact Heavy Duty  
Threaded Insert Setting Tool Kit

**Operating Instructions**

# 2746C-HD Compact Heavy Duty Threaded Insert Setting Tool Kit

## Operating Instructions

The Eclipse Compact Threaded Insert Setting Tool Kit has been designed to enable thin sheet nutserts to be placed quickly and easily by hand. It is invaluable to plant and maintenance Engineers, and also for DIY for simple assembly of threaded inserts or anchor nuts.

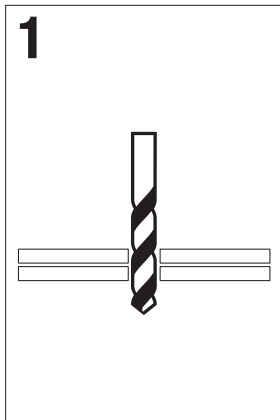

**1**  
Pre-drill appropriate size hole in the material to be inserted

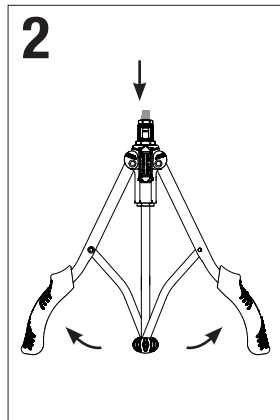

**2**  
Open the handles and fit nutset onto mandrel

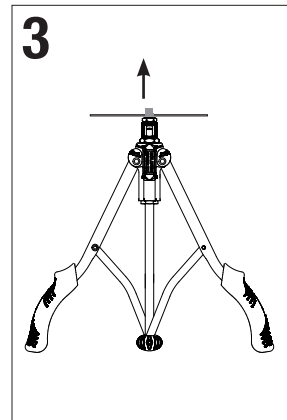

**3**  
Insert tool into pre-drilled hole

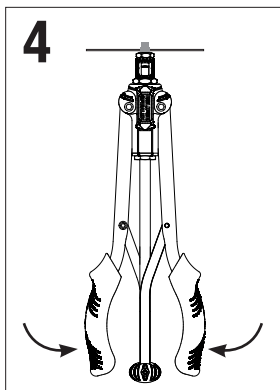

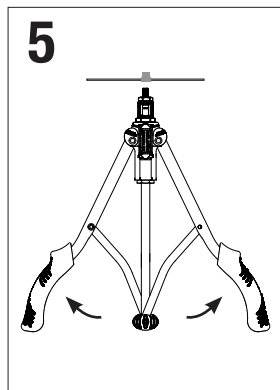

**4**  
Close the handles to set the nut in position



**5**  
Open the handles to unload the insert tool from the inserted nut

### \*Typical drill hole sizes

| Mandrel Sizes   | Drill Sizes |
|---|-------------|
|  M3  | 5 mm        |
|  M4  | 6 mm        |
|  M5  | 7 mm        |
|  M6  | 9 mm        |
|  M8  | 11 mm       |
|  M10 | 13 mm       |
|  M12 | 15 mm       |

\*Check with nutset supplier for appropriate hole size.

## Changing the Mandrel

- The mandrel can be changed without removing the sleeve by pushing back the sheath and unscrewing from the housing for easy changing of mandrel size
- The multi-functional spanner can be used to remove the nut piece and the sleeve if necessary.

