



VACUUM BRAKE FLUID BLEEDER SET

ISO 9001:2000

Instructions for use

Assembly and operating instruction

- For best service and proper safety, you should incorporate a regulator and inline filter when using an air compressor (not included) to operate the Brake Fluid Bleeder. (See Figure A.)

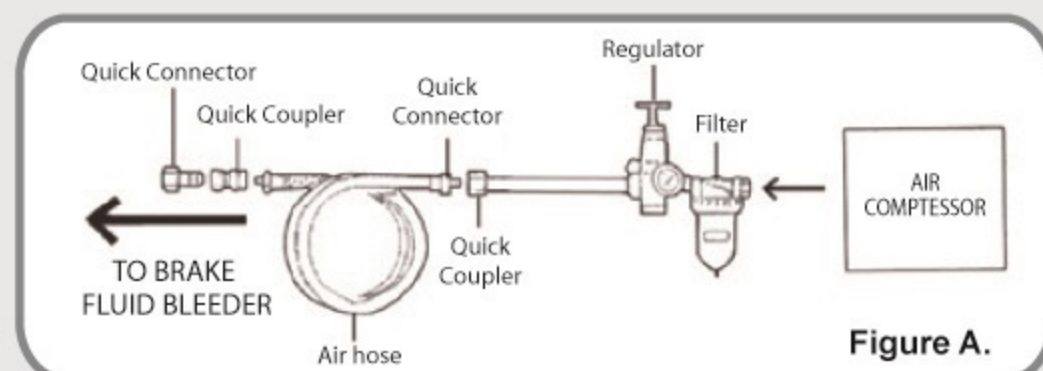

Figure A.

- Make sure the vehicle engine is off. Then, chock the vehicle wheels to prevent the vehicle from moving.
- Fill the New Fluid Supply Bottle (1) with up to 24 ounces of clean, new, brake fluid. (Use only the kind of brake fluid recommended by the vehicle manufacturer.) Then, screw the Supply Nozzle (2) onto the New Fluid Supply Bottle.
- NOTE: Make sure the Knob on the Supply Nozzle is turned to its "CLOSED" position. (See Figure B.)
- Remove the cap from the vehicle's master cylinder. Select the Adapter (3) which best fits the brake fluid fill hole in the master cylinder, and attach the Adapter to the Supply Nozzle (2). (See Figure B.)
- Turn the New Fluid Supply Bottle (1) upside down and insert its tube into the brake fluid fill hole of the master cylinder, making sure the Adapter (3) fits the fluid fill hole securely. Make sure the Knob on the Supply Nozzle is turned to its "OPEN" position. (See Figure B.)
- Screw the Gun Assembly (6) firmly onto the Old Fluid Container (4). Then, connect the Brake Bleeding Hose w/Connector (5) to the Old Fluid Container. (See Figure C)
- Determine the proper brake bleeding sequence from your vehicle service manual (i.e., right rear wheel, left rear wheel, right front wheel, left front wheel).
- Make sure to clean the vehicle brake caliper with brake parts cleaner (not included).
- Attach the Brake Bleeding Hose w/Connector (5) to the Bleeder Screw on the vehicle wheel. Then, connect the air compressor's air hose to the Handle of the Gun Assembly (6). (See Figure D.)
- Turn on the air compressor, and set its regulator at **90 to 120 PSI**.

Do not exceed **120 PSI**. (See Figure A.)

- Squeeze the Lever of the Gun Assembly (6) to create a vacuum in its Old Fluid Container (4). (See Figure D.)

- Using a bleeder screw wrench (not included), open the bleeder screw until brake fluid starts to flow through the Brake Bleeding Hose w/Connector (5). (See Figure D.)

- Squeeze the Lever of the Gun Assembly (6) until the old brake fluid flows freely into the Old Fluid Container (4). When clean, new brake fluid (with no bubbles) begins to flow into the Old Fluid Container discontinue squeezing the Lever of the Gun Assembly. Then, retighten the wheel's bleeder screw. (See Figure D.)

- Turn off the air compressor. Disconnect the Brake Bleeding Hose w/Connector (5) from the wheel's bleeder screw. Then, disconnect the air hose from the Gun Assembly. (See Figure D.)

- NOTE: When necessary, turn the Knob on the New Fluid Supply Bottle (1) to its "CLOSED" position. Refill the New Fluid Supply Bottle with clean, new brake fluid. Reattach the New Fluid Supply Bottle to the master cylinder, and turn its Knob to the "OPEN" position. Then, resume bleeding the brakes. (See Figure B.)

- NOTE: Also as necessary and after work is done, disconnect the air supply from the Gun Assembly (6). Empty the Old Fluid Container (4) of old brake fluid.

Reassemble the Gun Assembly and Old Fluid Container, and resume bleeding the brakes. (See Figure D.)

- Proceed to the vehicle's next wheel, and perform the same Steps as above.

- When finished using the Brake Fluid Bleeder, remove the New Fluid Supply Bottle (1). Check to make sure the master cylinder is full of brake fluid up to, but not over, its full line. (If the master cylinder is too full, correct this before proceeding.) Then, replace the cap on the master cylinder. (See Figure B.)

- WARNING! Before driving the vehicle, depress the brake pedal repeatedly until the brake pedal feels firm. Check the brake calipers for leaks. Then, test the brakes thoroughly at slow speed before operating the vehicle under normal conditions.

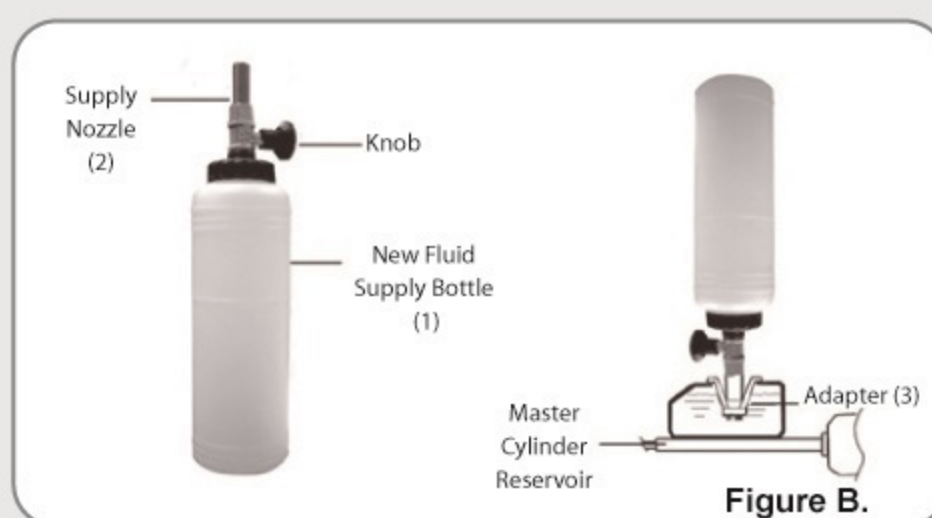

Figure B.



Figure C.

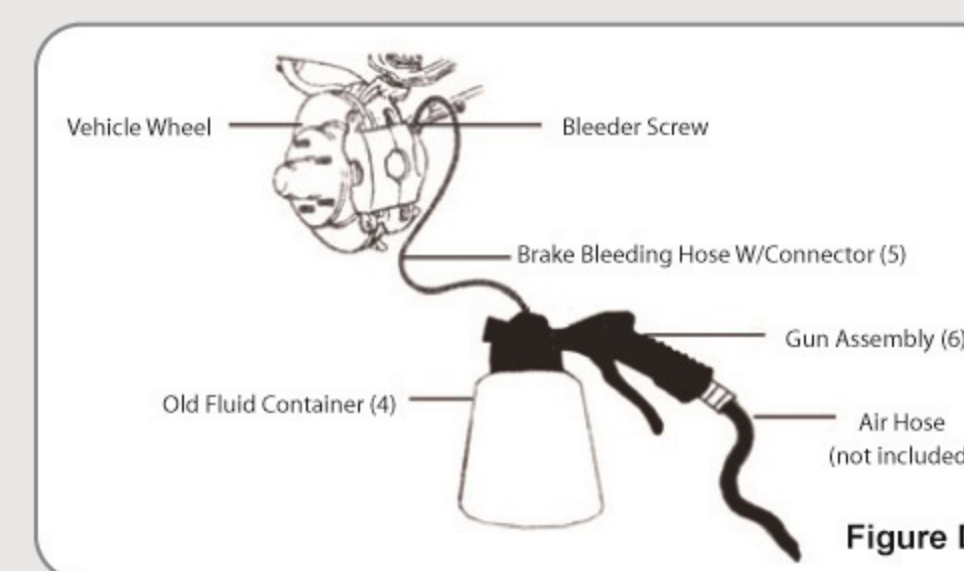

Figure D.

Inspection, Maintenance, and Cleaning

- Before each use:** Inspect the general condition of the Brake Fluid Bleeder. Check for misalignment or binding of moving parts, cracked or broken parts, damaged Hoses, loose connections, and any other condition that may affect its safe operation. If a problem occurs, have the problem corrected before further use. **Do not use damaged equipment.**
- When cleaning:** USE A CLEAN, DRY CLOTH ONLY. Do not use any cleaners, solvents, water, or other liquids.
- When storing:** Never store fluid in the New Fluid Supply Bottle (1) or the Old Fluid Container (4). Always dispose of excess fluid properly, according to federal, state, and local guidelines. Always store the Brake Fluid Bleeder in a clean, dry location out of reach of children.
- WARNING! All maintenance, service, or repairs not listed in this manual are only to be attempted by a qualified service technician.**

PLEASE READ THE FOLLOWING CAREFULLY

THE MANUFACTURER AND/OR DISTRIBUTOR HAS PROVIDED THE PARTS LIST AND ASSEMBLY DIAGRAM IN THIS MANUAL AS A REFERENCE TOOL ONLY. NEITHER THE MANUFACTURER OR DISTRIBUTOR MAKES ANY REPRESENTATION OR WARRANTY OF ANY KIND TO THE BUYER THAT HE OR SHE IS QUALIFIED TO MAKE ANY REPAIRS TO THE PRODUCT, OR THAT HE OR SHE IS QUALIFIED TO REPLACE ANY PARTS OF THE PRODUCT. IN FACT, THE MANUFACTURER AND/OR DISTRIBUTOR EXPRESSLY STATES THAT ALL REPAIRS AND PARTS REPLACEMENTS SHOULD BE UNDERTAKEN BY CERTIFIED AND LICENSED TECHNICIANS, AND NOT BY THE BUYER. THE BUYER ASSUMES ALL RISK AND LIABILITY ARISING OUT OF HIS OR HER REPAIRS TO THE ORIGINAL PRODUCT OR REPLACEMENT PARTS THERETO, OR ARISING OUT OF HIS OR HER INSTALLATION OF REPLACEMENT PARTS THERETO.

LIHYANN reserves the right to change product specifications without further notices

901076



Parts list & Assembly Diagram

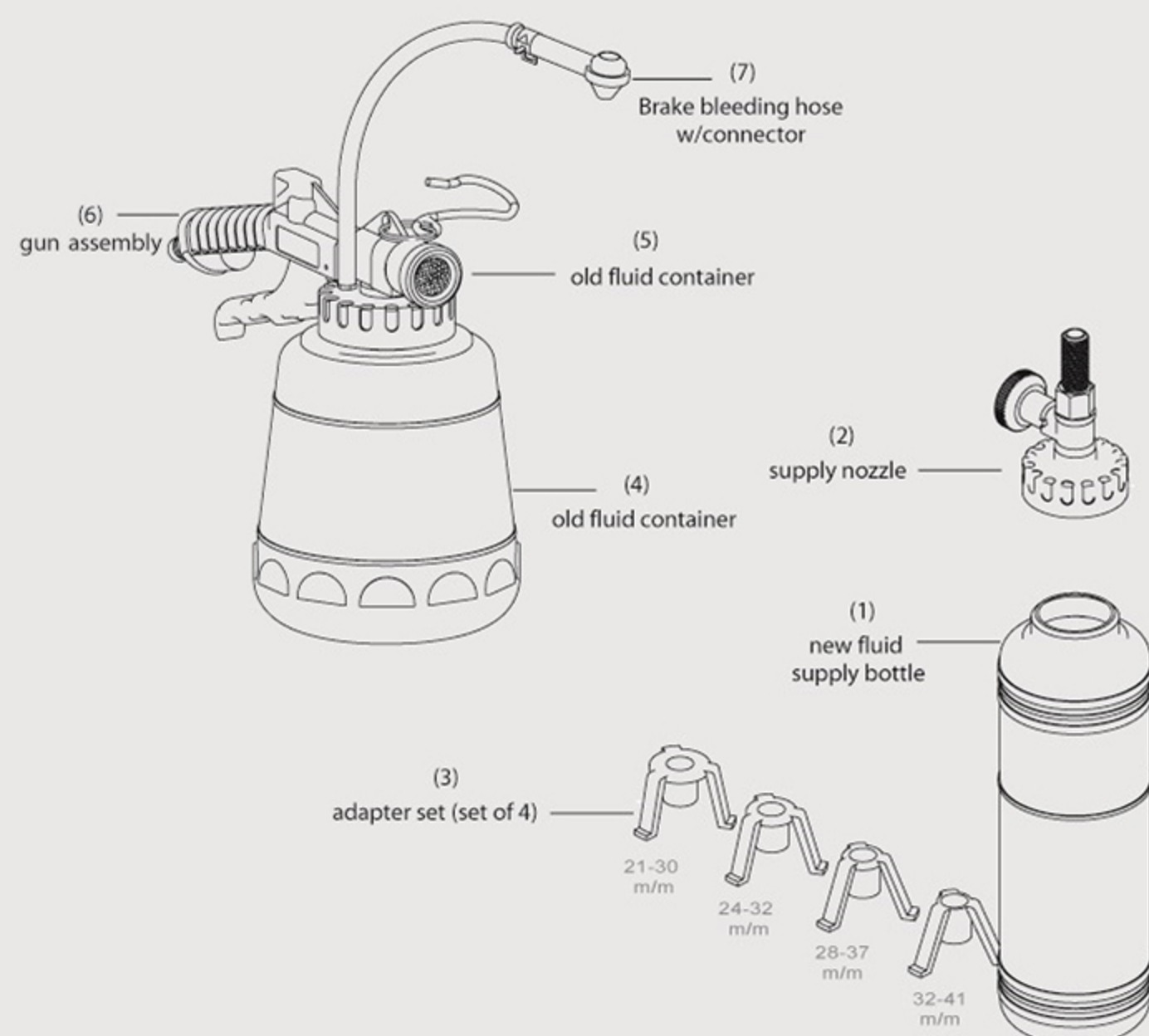

Note:

Some parts are listed and shown for illustration purposes only, and are not available individually as replacement parts.

Safety Warnings and Precautions

WARNING: When using tool, basic safety precautions should always be followed to reduce the risk of personal injury and damage to equipment.

Read all instructions before using this tool!

- Caution.** Maintain a safe working environment. Keep the work area well lit. Make sure there is adequate surrounding workspace. Always keep the work area free of obstructions, grease, oil trash, and other debris. Do not use the unit in areas near flammable chemicals, dusts and vapors.
- Observe work area conditions.** Do not use this unit in damp or wet locations. Do not expose to rain. Keep work area well lit. Do not use electrically powered compressors in the presence of flammable gases or liquids.
- Keep children away.** Children must never be allowed in the work area. Do not let them handle air lines, machines, tools, or extension cords.
- Warning.** Avoid accidental fire and/or explosion. Always work in a well-ventilated area and do not smoke near engine fuel and battery components.
- Store idle equipment.** When not in use, tools must be stored in a dry location to inhibit rust. Always lock up tools and keep out of reach of children.

Tool Use and Care

- Use the right tool for the job.** Do not attempt to force a small tool or attachment to do the work of a larger industrial tool. There are certain applications for which this tool was designed. It will do the job better and more safely at the rate for which it was intended. Do not modify this tool and do not use this tool for a purpose for which it was not intended.
- Maintain tools with care.** Keep tools maintained and clean for better and safer performance. Follow instructions for cleaning and changing accessories. Inspect air pressure hoses and fittings periodically if any. And, if damaged, have them repaired by a qualified technician. The handle must be kept clean, dry, and free from oil and grease at all times.
- Check for damaged parts.** Before using any tool, any part that appears damaged should be carefully checked to determine that it will operate properly and perform its intended function. Check for alignment and binding of moving parts; any broken parts or mounting fixtures; and any other condition that may affect proper operation. Any part that is damaged should be properly repaired or replaced by a qualified technician. Do not use the tool if the trigger does not operate properly.
- Replacement parts and accessories.** When servicing, use only identical replacement parts. Use of any other parts will void the warranty. Only use accessories intended for use with this tool.
- Disconnect power.** Disconnect tool from air supply or power when not in use.
- Maintenance.** For your safety, service and maintenance should be performed regularly by a qualified technician.

Personal Safety

- Dress properly.** Protective, electrically non-conductive clothes and non-skid footwear are recommended when working. Wear restrictive hair covering to contain long hair. Wear heavy work gloves.
- Use personal safety equipment.** Always wear safety approved impact glasses and full face mask when using this tool. Wear a safety approved dust mask.
- Do not overreach.** Keep proper footing and balance at all times. Do not reach over or across running machines.
- Stay alert.** Watch what you are doing, use common sense. Do not operate any tool when you are tired.
- Do not operate tool if under the influence of alcohol or drugs.** Read warning labels on prescriptions to determine if your judgment or reflexes are impaired while taking drugs. If there is any doubt, do not operate the tool.



VACUUM BRAKE FLUID BLEEDER SET

ISO 9001: 2000

WH-507B

- ☑ Vacuum brake bleeder complete with new fluid supply bottle.
- ☑ New fluid bottle adaptor set for different master cylinder designs.
- ☑ 1 litre capacity.
- ☑ Uses standard workshop air supply.
- ☑ Unique rubber joint for fluid extraction (avoids leaks).
- ☑ Removes fluid via bleed nipples to allow bleeding or entire fluid replacement.



Model	WH-507B
Material	PE
Capacity	1L
Power	Air Vacuum
Weight	820 gs

