

## No. 776Md

### Hinged hook wrench with pin and torque wrench socket

For nuts with radial holes to DIN 1816.

Special steel, hardened and blued.

Drive: square socket

EA613XP-1

EA613XP-2

**NEW!**

Order no.	Size	Drive SW [inch]	dia. D	L	S	T	T1	Weight [g]
52753	35-60	1/2	4	120	75	5	16,0	185
52761	60-90	1/2	6	168	100	6	16,0	320
565653	95-165	3/4	6	205	125	7	20,4	605

#### Note:

The set value for the torque wrench is dependant on insertion dimension „S“.

The operating manual provided with your torque wrench contains the requisite information and calculation formulae.

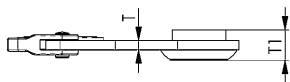
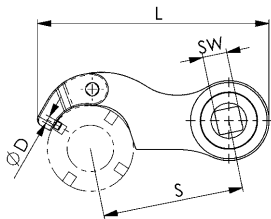

#### Recommendations



No. 771Md,  
page 50



No. 902Md,  
page 58



No. 250Md,  
page 57



Subject to technical alterations.