

HEAVY DUTY SQUARE PAD EYE

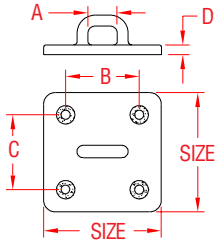

316 STAINLESS STEEL



ITEM	SIZE	A	B	C	D	WLL	WT
------	------	---	---	---	---	-----	----

S3704-0000 EA638GB-11	3"	0.94"	2.00"	2.00"	0.25"	3,000	0.66	
HD SQUARE BACKING PLATE (304 STAINLESS STEEL)							(lb)	(lb)
S3704-0001 EA638GB-11P	3"	1/4"	2.00"	2.00"	0.10"	N/A	0.28	

NOTE:
HEAVY DUTY, ONE PIECE PRECISION CASTING, WITHOUT WELDS. FOR MAXIMUM LOAD DISTRIBUTION USE HD BACKPLATE. USE 1/4" FASTENERS.

REFERENCE "FASTENER MATCHING CHART" (PAGE 158) FOR COMPATIBLE FASTENERS.

