

电子数显千分尺 使用说明书

重要声明

- 感谢您购买了本公司出品的产品。在使用之前, 请认真阅读本说明书。当您开始使用时, 本公司认为您已经认真阅读了本说明书。
- 如果本产品进行改进或技术变更, 恕不另行通知。

1

重要

- 购买本仪器后初次使用时, 请用蘸有清洗油的软布等擦去涂在产品上的防锈油。
- 如果连续3个月以上不使用本产品, 请取出电池并妥善保管。否则, 可能会发生电池漏液, 损坏产品。
- 为了成功阻止检测/显示模组部分受到水和灰尘的侵入, 安装电池时, 请拧紧电池盖, 另外请勿将垫圈取出。
- 请勿使用电笔在本产品上标写号码。
- 使用后请作防锈处理, 生锈后本仪器会发生故障。

安全注意事项

- 使用本产品时, 请遵守说明书上记载的规格、功能和使用注意事项。
- 超出使用范围会影响本产品的安全性能。
- 请勿拆解电池, 也不要使电池短路, 或擅自给电池充电或加热。否则可能引起电池发热、破裂及电池漏液进入人的眼中。
- 万一误吞入了电池, 要马上请医生检查。

2

技术规格

- 最小分辨率: 0.001mm或0.00005"
- 最大允许误差: $\pm 0.002\text{mm}$ 或 $\pm 0.0001"$ (25/50mm或1/2"), $\pm 0.003\text{mm}$ 或 $\pm 0.00015"$ (75/100/125/150mm或3/4/5/6"), $\pm 0.004\text{mm}$ 或 $\pm 0.0002"$ (175/200/225/250mm或7/8/9/10") $\pm 0.005\text{mm}$ 或 $\pm 0.00025"$ (275/300mm或11/12"), $\pm 0.006\text{mm}$ 或 $\pm 0.0003"$ (325/350/375/400mm或13/14/15/16"), $\pm 0.007\text{mm}$ 或 $\pm 0.00035"$ (425/450/475/500mm或17/18/19/20")
- 重复精度: 0.001mm或0.00005"
- 电源: CR2032电池 (锂锰扣式电池) 一个
- 电池寿命: 在一般状态下使用为2年
- 使用温度: 0°C-40°C
- 存放温度: -10°C-60°C
- 最大反应速度: 30mm/s

3

各部位的名称与功能

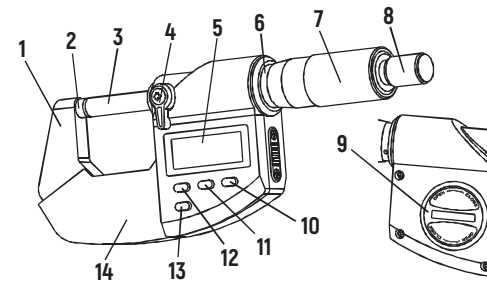

- | | |
|-----------|------------------------------|
| 1. 尺架 | 9. 电池盖 |
| 2. 测砧 | 10. HOLD/DATA按键屏幕保留测量值/数据采集) |
| 3. 测微螺杆 | 11. mm/in按键 |
| 4. 锁紧装置 | 12. ORIGIN按键 (进行原点的设定) |
| 5. LCD显示屏 | 13. N/O/ABS按键 |
| 6. 固定套管 | 14. 隔热装置 |
| 7. 微分筒 | |
| 8. 测力装置 | |

4

使用方法

重要

- 请务必使用CR2032电池 (锂锰扣式电池)
- 购入时所附的电池, 是用来确认本产品的功能及性能, 因此电池寿命可能无法满足您的要求。
- 装好电池后, 请务必进行ORIGIN (原点) 设定。
- 废电池请按照有关条例和规定处理。
- 装好电池后, 屏幕上会有“----”标志闪烁。如果这些标志不闪烁或显示, 请重新安装电池。
- 安装电池时, 若垂直压入, 可能会造成“+”端子损坏, 所以, 请一边将“+”端子往外推, 一边将电池斜滑推入。

- 1) 安装电池
 - 出厂时本产品已装入电池, 更换电池时请按照以下顺序装入电池。
 - 用准备好的电池 (CR2032) 将电池盖朝“OPEN”方向拧出。
 - 取出电池。
 - 将电池正极朝上装好。

5

请确认垫圈位置是否正确。

- 装上电池盖, 用取下的电池 (CR2032) 将电池盖朝“CLOSE”方向拧入。
 - 切勿取下密封垫圈。
- 2) ORIGIN (原点) 设定
 - 装好电池后, 屏幕上会闪烁显“----”标志。用软布或者软纸擦净测砧的面量和测微螺杆的面量, 用测力装置将量面置于闭合状态下 (量程>25mm的应借助校对杆) 持续按ORIGIN按键1秒以上。屏幕会显示「0.000」或“0.00000” (inch模式) 的数字, 表示ORIGIN (原点) 的设定已完成。
 - 若测微头零位刻线不重合, 用锁紧装置锁紧测微螺杆后再用扳子进行调整。

重要

- 装好电池时, 在按下ORIGIN下按键到确定原点值的期间内, 请不要转动微分筒。否则, 有可能造成错误计算。
 - 转动测力装置不能用力过猛。
- 3) mm/in (公英制) 切换
 - 每按mm/in按键一次, 公制显示与英制显示可以互相切换

6

4) HOLD/DATA (屏幕保留测量值/数据采集)

- 在无数据线连接的使用状态下, 快按HOLD DATA按键, H标识亮灯, 屏幕保留此刻的测量值 (可进行公英制切换)。再快按HOLDDATA按键一次, H标识灭灯, 回到通常的测量状态。
- 5) ON/ABS
 - 在测量结束后, 如果不转动刻度套管, 约20分钟后显示就会消失, 如果要再次显示请按ON/O/ABS按键。若150小时内, 不使用本产品, 再次开机, 需进行原点设定。
 - 快按ON/O/ABS按键, 变为比较测量的原点显示「0.000」或“0.00000” (inch模式) INC标识亮灯在INC模式下可以进行比较测量。
 - 进行INC长度测量时持续按ON/O/ABS按键一秒以上, 即显示绝对值 (INC标识灭灯)。

7

错误提示及对应措施

- 显示窗显示“”表示电池电压不足。请立即更换新电池。(参考使用方法步骤1)。
- 显示窗显示“Err_1”表示无法记数等情况, 快按ON/O/ABS屏幕闪烁显示标志, 然后参考使用方法步骤2) 重新设置ORIGIN (原点)。



8

INSTRUCTIONS FOR DIGITAL MICROMETER

Important Notice

- Before using this product, please read this manual carefully. When you begin to use it, you are considered to have read the instructions carefully.
- Any improvements or technical changes for this product will be without extra notice.

1

How to use

- Important**
- Use CR2032 Lithium manganese button cell only.
 - The battery supplied is used only for the purpose of checking the functions and performance of the digital micrometer, therefore it may not satisfy the specified battery life.
 - Set ORIGIN (0 position) after loading the battery.
 - Disposal of waste batteries must comply with the relevant discarding procedure and regulations.
 - "-----" will twinkle on the screen after loading the battery. If this symbol doesn't twinkle or is not shown reload the battery.
 - When loading the battery vertically, the battery may pin the positive pole bar and damage it. Hence, put asl ant the battery into the battery seat while pushing the positive pole bar aside.

- Loading the battery
 - Loading or replacing the battery must follow the following procedures.
 - Take off the battery cover by following the open arrow with the CR2032 battery.
 - Take out the flat battery.
 - Loading the battery with the positive pole facing upward.

5

Important

- Before using this digital micrometer for the first time, wipe the rust preventive oil from the digital micrometer with soft cloth soaked with cleaning oil.
- If the digital micrometer is not used for more than three months, take out battery and keep it.
- Otherwise, battery leakage may occur, and the leakage may damage the product.
- In order to prevent the water from entering the digital module, tighten the battery cover after loading the battery. Besides, do not take out the sealing O ring.
- Never apply voltage on any part of this product or engrave with an electrical pen on it.
- Anti-rust treatment shall be done after operation, rust may cause malfunction to this product.

Safety Precautions

- When using this product, please follow the directions, specifications and features given in this manual.
- Beyond the scope of use will affect the safety performance of the product.
- Do not dismantle the battery, do not make the battery short circuited. Never charge or heat the battery, or it may cause the battery heated, ruptured and the leakage of battery fluid may enter the eyes.
- If a battery is swallowed, immediately consult a doctor.

2

- Check the sealing o ring to ensure it's in the correct position.
 - Put on the battery cover, tighten the battery cover by following the close arrow with the waste CR2032 battery.
 - Never take off the sealing o ring.
- ORIGIN (0 setting)
 - "-----" will twinkle on the screen after loading the battery. Cleanse the measuring faces with a soft cloth. Turn the ratchet stop to close the measuring faces. Press ORIGIN button for more than one second, "0.000" or 0.00000 (inch mode) will be displayed on the screen, it shows the ORIGIN (0 position) has been set.
 - If the error of the micrometer head is within 0.02mm(0.01"), lock the spindle with the locking device, then turn the sleeve with the spanner wrench until the line on the sleeve coincides with the zero line on the thimble, then assemble the ratchet stop.

Important

- When pressing the ORIGIN button to set 0 after loading the battery, do not turn the thimble.
 - Otherwise, error may occur.
- mm/in [Metric and inch system conversion]
 - Press the mm/in button to switch to mm or inch mode alternately.

6

Specifications

- Resolution: 0.001mm /0.00005"
- Permissible error: 0.002mm(25/50mm)/±0.0001" (1/2"), ±0.003mm(75/100/125/150mm)/±0.00015" (3/4/5/6"), ±0.004mm(175/200/225/250mm) ±0.002" (7/8/9/10"), ±0.005mm(275/300mm)/ ±0.00025" (11/12"), ±0.006mm(325/350/375/400mm)/ ±0.0003" (13/14/15/16"), ±0.007mm(425/450/475/500mm)/ ±0.00035" (17/18/19/20").
- Repeatability: 0.001mm/0.00005"
- Battery: CR2032
- Battery life: 2 years
- Operating temperature: 0°C~40°C
- Storage temperature: -10°C~60°C
- Setting speed: 30mm/s

3

- HOLD/DATA [Measured value hold on the screen/data collect]
 - Press the button HOLD/DATA when the data cable is not connected to digital micrometer, "H" will be shown and the screen will hold the measured value (metric and inch system can be interchanged). Repress button HOLD/DATA, "H" will disappear. The digital micrometer will return to the previous state.
- ON/O/ABS
 - When the measurement is done, the display will disappear after 20 minutes if the thimble is not turned. If the display is needed, press the button ON/O/ABS. If this digital micrometer is not used for more than 150 hours, its origin needs to be set before measurement.
 - Quick press on button ON/O/ABS, INC is shown, it turns to the origin of relative measurement (0.000 or 0.00000 (inch mode) is shown). Relative measurement can be obtained in the mode of INC.
 - Press button ON/O/ABS for more than one second when it's in the state of INC, it shows absolute value. (INC disappear).

7

Components & Functions

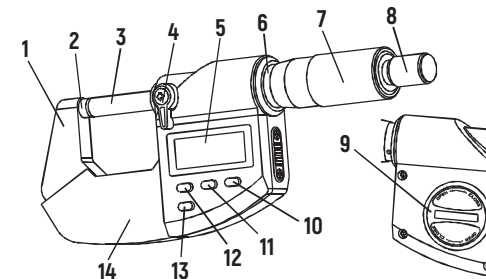

- | | |
|-------------------|--|
| 1. Frame | 9. Battery cover |
| 2. Anvil | 10. HOLD/DATA button [Measured values hold on screen/data collect] |
| 3. Spindle | 11. mm/in button |
| 4. Locking device | 12. ORIGIN button [0 position setting] |
| 5. LCD screen | 13. ON/O/ABS button |
| 6. Sleeve | 14. Insulant pad |
| 7. Thimble | |
| 8. Ratchet stop | |

4

Errors and Solutions

- "  " appears on the LCD means voltage is insufficient, please change new battery. (pls refer to "how to use" step 1).
- "Err_1" appears on LCD means cannot show the actual reading, pls press on/O/ABS till "-----" appears on the LCD, then refer to the "how to use" step 2, reset ORIGIN.



8