

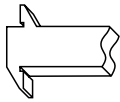

No. 6852 101

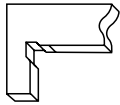

Digital-Tiefenmessschieber ULTRA active

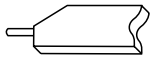
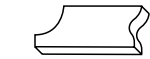
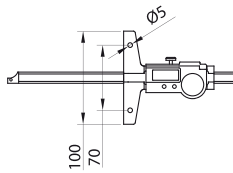

- ▶ DIN 862
- ▶ Feststellschraube
- ▶ rostfreier Stahl gehärtet
- ▶ großes LCD Display
- ▶ Batterie CR 2032 3V
- ▶ Tiefenmessbrücke mit Bohrung Ø 5mm und Bohrungsbstand 70mm für optionale Messbrücke
- ▶ Lieferung im Etui

Funktionen:

- ▶ Auto Ein/Aus
- ▶ mm/inch Umschaltung
- ▶ 0-Punkt an jeder Position

Digital depth calipers ULTRA active

Stangenquerschnitt
Bar cross section
16x4mm

- ▶ DIN 862
- ▶ Locking screw
- ▶ Hardened stainless steel
- ▶ Large LCD display
- ▶ Battery CR 2032 3V
- ▶ Measuring bridge with bore Ø 5mm and bore distance 70mm for optional measuring bridge
- ▶ Delivered in a case

Functions:

- ▶ Auto On/Off
- ▶ mm/inch commutation
- ▶ Zero setting at any position

mm	inch	mm	mm	inch	kg	Nº
Abgeschrägte Spitze / Bevelled point						
150	6	100	0,01	.0005	0,4	6852 101
200	8	100	0,01	.0005	0,44	6852 102
300	12	100	0,01	.0005	0,7	6852 103
Stahlstift gehärtet / Steel pin hardened EA725FC-11A						
150	6	100	0,01	.0005	0,42	6852 111
200	8	100	0,01	.0005	0,44	6852 112
300	12	100	0,01	.0005	0,7	6852 112
Winkelhaken / Hook						
150	6	100	0,01	.0005	0,42	6852 121
200	8	100	0,01	.0005	0,46	6852 122
300	12	100	0,01	.0005	0,58	6852 123
Versetzte Messflächen / Offset measuring faces						
150	6	100	0,01	.0005	0,42	6852 131
200	8	100	0,01	.0005	0,46	6852 132
300	12	100	0,01	.0005	0,56	6852 133
Messbrücke 300mm / Measuring bridge 300mm						
Messbrücke 500mm / Measuring bridge 500mm						
						6852 191
						6852 192

Digital-Tiefenmessschieber ULTRA active mit extra langem Stahlstift



Extra langer Stahlstift
Länge 22mm / Ø 1,5mm
Extra long steel pin
length 22mm / Ø 1,5mm



No. 6852 141

- ▶ Werksnorm
- ▶ Feststellschraube
- ▶ rostfreier Stahl gehärtet
- ▶ großes LCD Display
- ▶ Batterie CR 2032 3V
- ▶ Lieferung im Etui

Funktionen:

- ▶ Auto Aus
- ▶ mm/inch Umschaltung
- ▶ 0-Punkt an jeder Position

Digital depth calipers ULTRA active with extra long steel pin

- ▶ Works standard
- ▶ Locking screw
- ▶ Hardened stainless steel
- ▶ Large LCD display
- ▶ Battery CR 2032 3V
- ▶ Delivered in a case

Functions:

- ▶ Auto Off
- ▶ mm/inch commutation
- ▶ Zero setting at any position

mm	inch	mm	mm	inch	mm	kg	Nº
0 - 25	0 - 1	0,01		.0005	± 0,03	0,2	6852 141