

MX SERIES

COOL LOOK, COOL COMFORT



NRR
30
dB

SLC₈₀
34dB
Class 5

6130 MX-6

EA800WM-10

NRR
27
dB

SLC₈₀
32dB
Class 5

MOLDEX
Ideas that wear well.®

The MX-5 and MX-6 are a cool and comfortable upgrade in earmuffs. The larger cup openings are designed to fit most ear sizes. The cushion-ribbed headband allows cool comfort all day long and the non-slip wire makes adjustments easy. The MX-5 and MX-6 are easy to wear and durable, have a sharp, cool look and increase compliance.

MX-5 AND MX-6

- Soft cushion-ribbed open air headband for cool comfort all day long
- Overmolded headband is durable for rugged wear over many shifts
- Larger ear cushions allow freedom to fit almost all ears comfortably
- Lightweight wire frame allows easy cup adjustment yet holds its position for lasting comfort
- Cool looks and comfort to promote worker acceptance and compliance
- Extra soft foam/low pressure cushions and headband are PVC-Free
- Glossy surface for easy cleaning and longer wear
- Independently tested for protection you can count on
- MX-6 features exclusive waffled cup foam for superior protection
- PVC-Free for a greener alternative



6120 MX-5

WARNING:

1. Use this laboratory derived attenuation data for comparison purposes only. The amount of protection afforded in field use often is significantly lower depending upon how the protectors are fitted and worn.
2. Failure to follow all instructions could result in hearing loss or injury.
3. Failure to obtain a proper fit will reduce effectiveness of hearing protectors and could result in hearing loss or injury.
4. Over protection can be dangerous. The wearer must be able to hear warning signals.
5. Wearers with hearing loss should exercise extreme caution.
6. It is the employer's responsibility to ensure that the type of hearing protector and its NRR rating is appropriate for the user in their particular workplace.
7. Failure to follow these warnings could result in serious injury or death.
8. Moldex earmuffs must only be used as part of a hearing conservation program that complies with applicable local safety and health regulations.

INFORMATION REQUIRED BY EPA:

"The level of noise entering a person's ear, when a hearing protector is worn as directed, is closely approximated by the difference between the A-weighted environmental noise level and the NRR."

EXAMPLE:

- 1) The environmental noise level as measured at the ear is 92 dBA.
- 2) The NRR is 33 decibels (dB).
- 3) The level of noise entering the ear is approximately equal to [92 dB(A) - 33] 59dB(A)."

CAUTION:

"For noise environments dominated by frequencies below 500 Hz the C-weighted environmental noise level should be used. Improper fit of this device will reduce its effectiveness in attenuating noise. Consult the enclosed instructions for proper fit. Although hearing protectors can be recommended for protection against the harmful effects of impulsive noise, the Noise Reduction Rating (NRR) is based on the attenuation of continuous noise and may not be an accurate indicator of the protection attainable against impulsive noise such as gunfire."

INSTRUCTIONS FOR USE:

MX-5/MX-6 Series Earmuffs must be fitted and worn correctly to provide effective protection. Earmuffs and their cushions may deteriorate with use and should be examined for cracking or other deformations and replaced as necessary. Routinely wash with mild soap and water. The foam liner should be allowed to air dry before reinserting into the earcups.

- 1) With headband over-the-head, pull the cups outward and position over your ears so that they fully enclose the ear and seal tightly against the head.
- 2) Adjust the height of the cups until you have a tight and comfortable fit. For best results, remove all hair from under the cushions.
- 3) Maintenance: Replace cushions and foam inserts at least twice a year for hygiene and safety. For MX-5 order Part No. 6125 and for MX-6 order Part No. 6135. For MX-6 only: Place the glossy side of the foam against the cup.

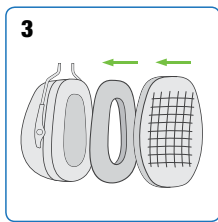
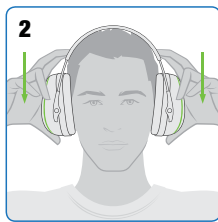
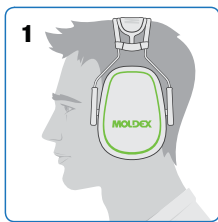
**Ordering Information**

Part #	Description	NRR	SLC ₈₀	Quantity Per Box/Bag
6120	MX-5 Earmuff	27dB	32dB/Class 5	1 Earmuff
6130	MX-6 Earmuff	30dB	34dB/Class 5	1 Earmuff
6125	MX-5 Hygiene Kit			1 Kit
6135	MX-6 Hygiene Kit			1 Kit

EA800WM-10**EA800WM-11**

MOLDEX
Ideas that wear well.

MOLDEX-METRIC, INC.

Moldex-Metric, Inc.
10111 West Jefferson Blvd., Culver City, CA 90232
TEL: +1 (800) 421-0668 or +1 (310) 837-6500
FAX: +1 (310) 837-9563
E-mail: sales@moldex.com
www.moldex.com

MOLDEX TECHNICAL SERVICE DEPARTMENT:

+1 (800) 421-0668 or
+1 (310) 837-6500 ext. 512/550
Moldex is a registered trademark.
U.S. Patents Pending

6120-709 REV A 5/14

MX-5 EARMUFFS**ATTENUATION DATA / DATOS DE ATENUACIÓN / DONNÉES D'ATTÉNUATION**

Tested According to ANSI Specs S3.19-1974 Michael & Assoc., State College, PA.
Probado de acuerdo a las especificaciones ANSI S3.19-1974 Michael & Assoc., State College, PA.
Tests Conformes aux Spéc. ANSI S3.19-1974 Michael & Assoc., State College, PA.

Frequency (Hz) Frecuencia (Hz) Fréquence (Hz)	125	250	500	1000	2000	3150	4000	6300	8000		
Mean Attenuation (dB) Datos de Atenuación (dB) Atténuation Moyenne (dB)	20.6	23.6	32.3	39.9	40.2	36.8	36.7	37.1	36.8	NRR 27	CSA AL
Standard Deviation (dB) Desviación Estándar (dB) Écart Standard (dB)	3.2	2.3	3.3	3.1	2.6	2.9	3.1	3.2	3.6		

MX-6 EARMUFFS**ATTENUATION DATA / DATOS DE ATENUACIÓN / DONNÉES D'ATTÉNUATION**

Tested According to ANSI Specs S3.19-1974 Michael & Assoc., State College, PA.
Probado de acuerdo a las especificaciones ANSI S3.19-1974 Michael & Assoc., State College, PA.
Tests Conformes aux Spéc. ANSI S3.19-1974 Michael & Assoc., State College, PA.

Frequency (Hz) Frecuencia (Hz) Fréquence (Hz)	125	250	500	1000	2000	3150	4000	6300	8000		
Mean Attenuation (dB) Datos de Atenuación (dB) Atténuation Moyenne (dB)	21.8	25.6	33.5	37.7	40.7	42.6	43.6	44.6	43.2	NRR 30	CSA AL
Standard Deviation (dB) Desviación Estándar (dB) Écart Standard (dB)	2.5	1.6	2.0	3.1	2.8	3.7	2.8	3.2	3.3		

MX-5 EARMUFFS**ATTENUATION DATA FOR AUSTRALIA / NEW ZEALAND**

Tested According to AS/NZS 1270 by Michael & Associates.
Note: For full details of methods of selecting a hearing protector, see AS/NZS 1269.3
Hearing protector Class 5 tested to AS/NZS 1270. When selected, used and maintained as specified in AS/NZS 1269.3, this protector may be used in noise up to 110dB(A) assuming an 85dB(A) criterion.
A lower criterion may require a higher protector class.

Frequency (Hz)	125	250	500	1000	2000	4000	8000	
Mean Attenuation (dB)	19.0	22.1	31.4	37.2	36.8	35.1	36.6	SLC ₈₀ 32dB, Class 5
Standard Deviation (dB)	3.0	2.8	3.3	3.5	3.0	3.4	3.9	
Mean Minus Standard Deviation (dB)	16.0	19.3	28.1	33.7	33.8	31.7	32.7	

MX-6 EARMUFFS**ATTENUATION DATA FOR AUSTRALIA / NEW ZEALAND**

Tested According to AS/NZS 1270 by Michael & Associates.
Note: For full details of methods of selecting a hearing protector, see AS/NZS 1269.3
Hearing protector Class 5 tested to AS/NZS 1270. When selected, used and maintained as specified in AS/NZS 1269.3, this protector may be used in noise up to 110dB(A) assuming an 85dB(A) criterion.
A lower criterion may require a higher protector class.

Frequency (Hz)	125	250	500	1000	2000	4000	8000	
Mean Attenuation (dB)	21.5	24.4	32.7	38.3	39.2	44.0	39.4	SLC ₈₀ 34dB, Class 5
Standard Deviation (dB)	3.4	2.7	3.2	3.7	3.0	3.8	4.6	
Mean Minus Standard Deviation (dB)	18.1	21.7	29.5	34.6	36.2	40.2	34.8	



Printed on Recycled Paper

AUSTRALIA

Unit 30/14-16 Stanton Road,
Seven Hills, NSW 2147
TEL: +61 (02) 9838 7588
FAX: +61 (02) 9838 7544
E-mail: moldexaustralia@moldex.com
www.moldex.com

NEW ZEALAND

3 Spence Road
Henderson, Auckland, NZ
TEL: +64 (9) 837 8247
FAX: +64 (9) 837 8248
E-mail: moldexnz@moldex.com
www.moldex.com

