

# **K** **KEEPER** PERFORMANCE ENGINEERED™ **WINCHES**



## **Assembly & Operating Instructions** **KW7.5RM**

**7500 lbs 12V DC Electric Winch**



**CAUTION!**



**READ AND UNDERSTAND THIS MANUAL BEFORE INSTALLATION  
AND OPERATION OF THIS PRODUCT.**

**DO NOT RETURN THIS PRODUCT TO SELLER.  
CALL KEEPER WINCH AT 800-533-7372 FOR ASSISTANCE**

Hampton Products International Corp.  
50 Icon  
Foothill Ranch, CA 92610 USA  
800-533-7372  
[www.keeperwinches.com](http://www.keeperwinches.com) or [winches@hamptonproducts.com](mailto:winches@hamptonproducts.com)

KW7.5RM 7500 lb 12V DC Electric Winch

Designed for Utility Recovery, and General Utility Winching Applications.  
THIS PRODUCT IS NOT INTENDED FOR LIFTING/HOISTING

Safety Precautions

**CAUTION**  
PLEASE READ ALL SAFETY PRECAUTIONS AND WARNINGS BEFORE INSTALLING AND USING THE WINCH! IF YOU HAVE QUESTIONS PLEASE SEND A MESSAGE VIA [WINCHES@HAMPTONPRODUCTS.COM](mailto:WINCHES@HAMPTONPRODUCTS.COM) OR CALL 1 800-533-7372

The Danger, Warnings, Cautions, and Instructions discussed in this instruction manual cannot cover all possible conditions and situations that may occur. It must be understood by the operator that common sense and caution are factors which cannot be built into this product, but must be supplied by the operator.

- DANGER** Indicates an imminently hazardous situation which, if not avoided, will result in death or serious injury.
- WARNING** Indicates a potentially hazardous situation which, if not avoided, could result in death or serious injury.
- CAUTION** Indicates a potentially hazardous situation which, if not avoided, may result in minor or moderate injury. This notation is also used to alert against unsafe practices.

**Note:** Indicates additional information in the installation and operation procedures of your winch.

Introduction

Thank you for purchasing your KEEPER® Winch.

PLEASE READ ALL INSTRUCTIONS, PAYING SPECIAL ATTENTION TO THE SAFETY INSTRUCTIONS.

Your KEEPER® Winch has been designed and manufactured to provide years of trouble-free operation. If you are not satisfied, for any reason, please contact Customer Service at 800-533-7372, visit our website: [www.keeperwinches.com](http://www.keeperwinches.com) or contact [winches@hamptonproducts.com](mailto:winches@hamptonproducts.com). When requesting information in regard to this winch, please give the following information:  
Winch Part # \_\_\_\_\_ and Serial number \_\_\_\_\_.  
(Please write down this information here for future reference.) (Found on Motor Housing)  
Please read and understand this Owner's Manual prior to installing and operating this product.

PAY PARTICULAR ATTENTION TO THE GENERAL SAFETY INFORMATION.

Your Winch is a powerful machine. If used unsafely or improperly, there is a possibility that property damage and/or personal injury can result. Your safety ultimately depends on your caution when using this product.

Save this Manual

You will need this manual for the safety warnings and cautions, assembly instructions, operating procedures, maintenance procedures, trouble shooting, parts list, and diagram. Keep your invoice with this manual. Write the invoice number on the inside of the front cover. Keep both this manual and your invoice in a safe, dry place for future reference.

KW7.5RM SPECIFICATIONS

Part Number:	KW75122 - with Wireless
Rated Line Pull:	7,500 lbs., 3,402 kg.
Motor - Series Wound:	4.5 hp 12V DC
Control:	Handheld Pendant Switch on 15' Lead with Built-in High Density Light
Switching:	High Duty Cycle Integrated Sealed Solenoid Pack and KTA14126 Wireless
Gear Train:	High Efficiency 3-Stage Planetary Gear Set
Gear Reduction:	180:1
Clutch (Freespooling):	Lift and Turn
Brake:	Mechanical Automatic
Wire Rope:	72' (22.00 m) of 5/16ths (8.0 mm) Diameter Galvanized Wire Rope with Looped Thimble, Latched Clevis Hook and Red Warning Area.
Drum Diameter/Length:	Diameter - 2.5" (63.5 mm) / Length - 6.6" (152 mm)
Fairleads:	4-way Roller
Battery Leads:	2 Gauge: Front Mount 2' motor leads with Quick Connect and 6'harness with Quick Connect
Battery:	Minimum 650 CCA
Application:	General Utility Load Recovery/Trailer, Truck, Tractor, Equipment
Finish:	High-Gloss gray Powder Coat over Undercoating
Weight:	76 lbs. / 35 kg.
Warranty	Limited Lifetime: See Warranty

Winch Dimensions and Mounting Bolt Pattern

FIGURE 1

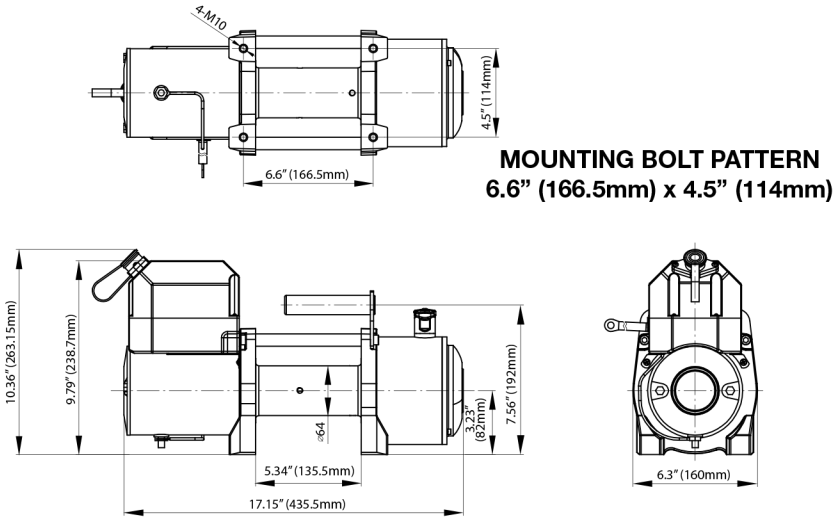

## General Description

This KEEPER® Winch is equipped with a series wound, 12 Volt DC motor and is designed for **INTERMITTENT GENERAL DUTY USE**. This electric winch is similar to most electric motor driven tools and should not be allowed to become overly hot. Stop winch if motor starts to labor or end of motor becomes hot to the touch. Stop winching and allow motor to cool down. Minimum electrical requirements are 60 amp alternator and battery with 650 CCA (cold cranking amp) capacity. This Winch (**FIGURE 2**) is not intended for use in lifting/hoisting applications and the manufacturer does not warrant it to be suitable for such use. The Freespool Clutch disengages the gearbox to allow the wire rope to be pulled out without using electric power. A Remote Switch with 15' lead and wireless switch allows a wide variety of mounting options.

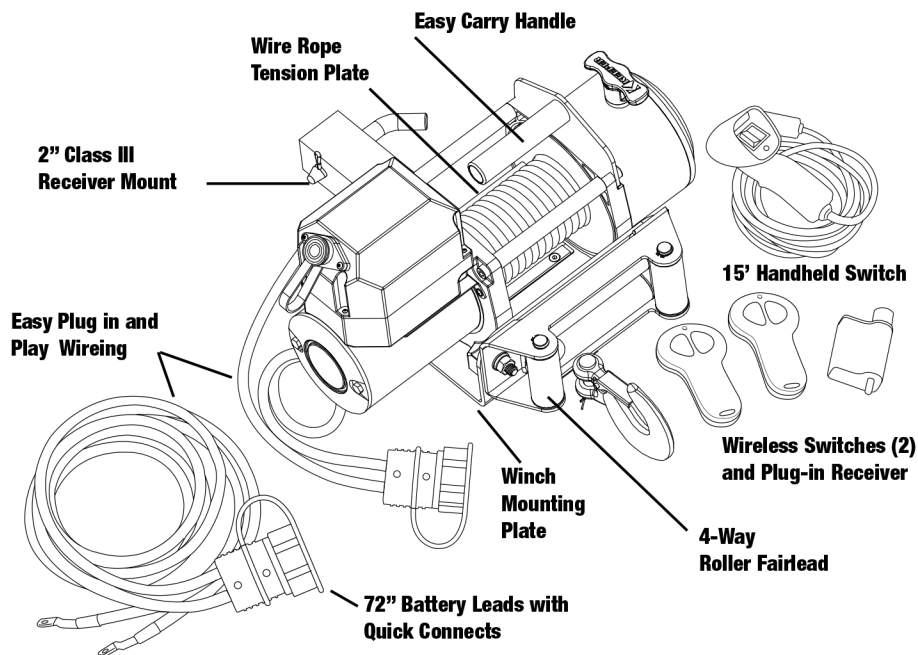

## 12V DC PERFORMANCE

Line Pull Lbs. (kg)	Line Speed FPM (MPM)	Motor Amp Dr	Pull By Layer Lbs. (kg)
0	35 (10.7)	25	1 @ 7500 (3402)
500 ( 227)	32 ( 9.8)	37	2 @ 6525 (2960)
1500 ( 680)	25 ( 7.6)	155	3 @ 5547 (2516)
3500 (1588)	15 ( 4.6)	230	4 @ 4715 (2139)
5500 (2495)	11 ( 3.4)	298	
7500 (3402)	9 ( 2.7)	356	

## Rolling Load Capacities (1<sup>st</sup> Layer)

SLOPE*	10% (5.7°)	20% (9°)	40% (18°)	60% (27°)	100% (45°)
Lbs.	48,450	32,400	20,900	16,150	13,600
Kgs.	22,980	14,700	9,480	7,320	6,170

\*SLOPE: a one (1') rise over ten (10') feet in length equals a GRADE of 10%. A 10% grade is equal to a 5.71° incline angle. A 100% grade equals a 45° angle of incline.

## General Safety Warnings & Cautions

**1. READ AND UNDERSTAND THIS MANUAL BEFORE OPERATING YOUR WINCH.** After installing the Winch, practice using it before the need arises. **NEVER ALLOW PERSONS UNFAMILIAR WITH THIS PRODUCT TO OPERATE IT. ALWAYS WEAR SAFETY GLASSES AND LEATHER GLOVES WHILE WORKING WITH MACHINERY.**

**2. DO NOT EXCEED RATED CAPACITY OF THE WINCH. DO NOT OVERLOAD! DO NOT ATTEMPT PROLONGED PULLS OF HEAVY LOADS!**

Overloads can damage the Winch and/or the wire rope and create unsafe operating conditions. **FOR LOADS OVER 75% OF THE RATED WINCH CAPACITY, WE RECOMMEND THE USE OF A PULLEY BLOCK (KWA14550 not included) TO DOUBLE LINE THE WIRE ROPE (Figure 3).** This reduces the load on the Winch, the strain on the wire rope and electrical system.

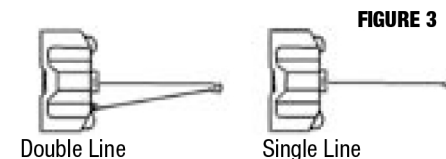

**3. Never apply a load to your winch with the wire rope fully extended.** Keep at least 5 wraps on the winch drum.

**4. THE VEHICLE ENGINE SHOULD BE RUNNING DURING WINCH OPERATION.** If winching is performed with the engine turned off, the battery may be too weak to restart the engine.

**5. DO NOT** operate your vehicle to assist the Winch in pulling the load. The combination of the Winch and vehicle pulling together could overload the wire rope and the Winch.



**6. WHEN IN USE, ALWAYS STAND CLEAR OF WIRE ROPE, HOOK AND WINCH.**

**7. INSPECT WIRE ROPE AND EQUIPMENT FREQUENTLY. A FRAYED, KINKED OR FLATTENED WIRE ROPE NEEDS TO BE REPLACED IMMEDIATELY.** Periodically check the Winch installation to ensure that all bolts are tight.

**8. USE HEAVY LEATHER GLOVES** when handling wire rope. **DO NOT LET WIRE ROPE SLIDE THROUGH YOUR GLOVED OR UNGLOVED HANDS. ALWAYS USE THE HAND-SAVER STRAP** when guiding the wire rope in or out (**Figure 4**).

**9. NEVER WINCH WITH LESS THAN 5 WRAPS OF WIRE ROPE AROUND THE WINCH DRUM** since the wire rope end and fastener may **NOT** withstand full load.

**FIGURE 4**

**10. KEEP CLEAR OF WINCH, TAUT WIRE ROPE AND HOOK WHEN OPERATING WINCH. NEVER STEP OVER TAUT WIRE ROPE.**

**11. NEVER HOOK THE WIRE ROPE BACK ONTO ITSELF.** This will damage the wire rope. Use a **KEEPER 02953 3" X 6" WINCH STRAP**, sling, tree saver or other recommended accessory for this type connection (**Figure 5**).

**12. NEVER USE YOUR WINCH FOR LIFTING OR MOVING PEOPLE!**

**13. YOUR WINCH IS NOT INTENDED FOR OVER HEAD HOISTING OPERATIONS.**

**14. AVOID CONTINUOUS PULLS FROM EXTREME ANGLES.** This will cause the wire rope to pile and jam in the Winch, causing damage to the wire rope or Winch (**Figure 6**).

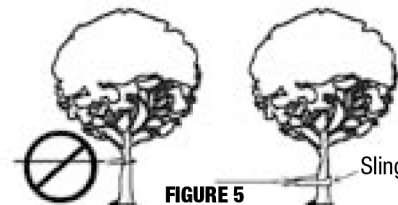

**FIGURE 5**

## ⚠ General Safety Warnings & Cautions (Continued) ⚠

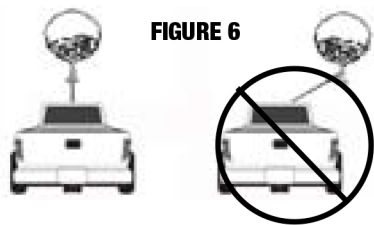
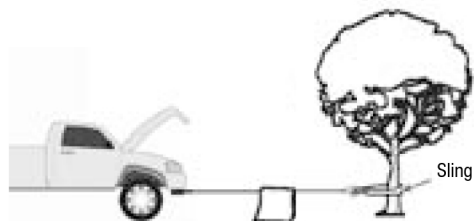

FIGURE 6

FIGURE 7



15. NEVER OBSCURE THE WARNING INSTRUCTION LABELS ON THE WINCH.

16. It is highly recommended to lay a heavy cloth (such as a blanket or tarp) over the wire rope when pulling heavy loads (Figure 7). If a wire rope failure should occur, the cloth will act as a damper and help prevent the wire rope from whipping. If mounted on the front of a vehicle then raise the hood for further protection.

17. Always operate Winch with an unobstructed view of the Winching operation.

18. Equipment such as hooks, pulley blocks, straps, etc. should be sized for winch capacity and periodically inspected for damage that could reduce their strength.

19. NEVER RELEASE FREESPOOL CLUTCH WHEN THERE IS A LOAD ON THE WINCH.

20. NEVER WORK ON OR AROUND THE WINCH DRUM WHEN WINCH OR WIRE ROPE IS UNDER LOAD.

21. DO NOT OPERATE WINCH WHEN UNDER THE INFLUENCE OF ANY DRUGS OR ALCOHOL.

22. ALWAYS DISCONNECT WINCH POWER LEADS TO BATTERY BEFORE WORKING ON OR AROUND THE WINCH DRUM so that Winch cannot be turned on accidentally.

23. When moving a load, slowly take up wire rope slack until it is taut. Stop, recheck all Winching connections. Be sure the hook is properly seated. If a nylon sling is used, check the attachment to the load.

24. When using a vehicle mounted Winch to move a load, place the vehicle transmission in neutral (never in Park), set vehicle hand-brake, and chock all wheels.

25. DO NOT USE THE WINCH TO HOLD LOADS IN PLACE. Use other means of securing loads such as KEEPER brand tie-down straps. For tie-down information go to [www.keepercorp.com](http://www.keepercorp.com)

26. USE ONLY FACTORY APPROVED SWITCHES, ADAPTERS, REMOTE CONTROLS AND ACCESSORIES. Use of non-factory approved components may cause injury or property damage and could void your warranty.

27. DO NOT MACHINE OR WELD ANY PART OF THE WINCH. Such alteration may weaken the structural integrity of the Winch and could void your warranty.

28. This is a 12 Volt DC Winch. CONNECT ONLY TO 12 VOLT DC BATTERY. DO NOT CONNECT WINCH TO EITHER 110V OR 220V AC CURRENT AS WINCH WILL BURN OUT OR FATAL SHOCK WILL OCCUR. This will void warranty.

29. Never allow shock loads to be applied to Winch or wire rope.

30. USE EXTREME CAUTION WHEN WINCHING A LOAD UP AND DOWN A RAMP OR INCLINE.

31. Keep people, pets, and property clear of Winching path, front, rear and sides for 80'.

32. NEVER EXCEED RATING OF YOUR RECIEVER HITCH.

THIS PRODUCT IS NOT INTENDED FOR LIFTING / HOISTING

## Winch Installation

Correct installation of your Winch is required for proper operation. Installation should be on a flat surface following the bolt pattern shown in FIGURE 1.

Read and follow directions carefully to ensure proper Winch alignment and trouble free operation. This Winch **MUST** be mounted with the wire rope in the under-wind direction (FIGURE 8). **MUST** use only genuine Keeper Winch replacement Wire Rope part number 72' x 5/16" KWA14613.

### ⚠ WARNING ⚠

Improper mounting could damage your Winch and void your warranty.

### ⚠ WARNING ⚠

DO NOT EXCEED THE RATING OF YOUR RECIEVER HITCH

**Step 1** Mount the Winch to the mounting kit base plate, proper mounting bolts are supplied. If using the Roller Fair Lead included, install now to mounting plate. You may need to remove one or more of the rollers on the roller fairlead to pass through the wire rope. After doing this you may now attach the clevis hook. See (Figure 8) for order and bolt direction.

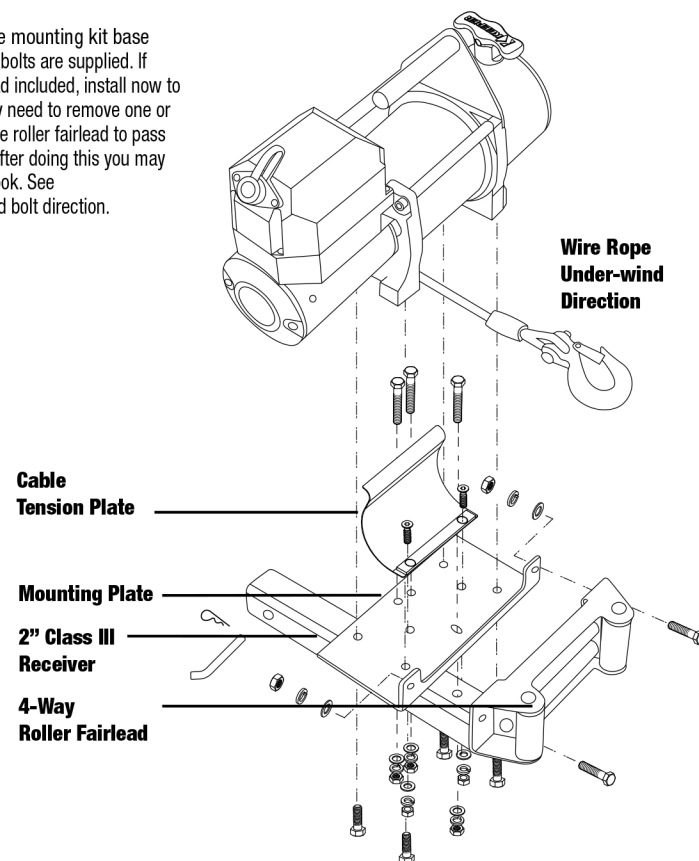

FIGURE 8

THIS PRODUCT IS NOT INTENDED FOR LIFTING / HOISTING



## Winch Installation (Continued)



### WARNING

USE ONLY 3/8" -16 UNC BOLT AND NUTS WITH MINIMUM ISO GRADE 8.8.



### WARNING

Batteries contain gases, which are flammable and explosive. **WEAR EYE PROTECTION DURING INSTALLATION AND REMOVE ALL METAL JEWELRY.** Do not lean over battery while making connections.



### WARNING

Ensure that the wiring harness does not interfere or come in contact with any hot or moving engine, suspension, steering, braking or exhaust parts.

**MINIMUM ELECTRICAL REQUIREMENTS ARE 60 AMP ALTERNATOR AND BATTERY WITH 650 CCA (COLD CRANKING AMP) CAPACITY.**

- Step 2** Follow electrical connection diagram (FIGURE 9). Bolt the circuit breaker to the terminal end of the Red 2 GA battery lead that is factory connected to the sealed solenoid switching pack. Now connect the circuit breaker to the positive battery terminal.

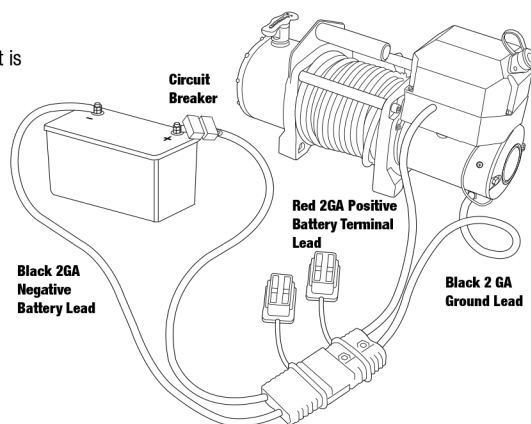

- Step 3** Connect Black 2 GA battery lead to the negative motor terminal located on the bottom of the motor and also connect the Black 2 GA ground lead from the solenoid pack to the same negative motor terminal.
- Step 4** Connect the other terminal end of the Black 2 GA battery lead to the negative battery terminal. If longer wiring harness is required then purchase KWA14607.
- Step 5** Remove the dust cover on the plug receptacle and insert the plug end of the handheld pendant switch. The plug end is keyed and will fit easily onto the socket only one way. **DO NOT FORCE.**
- Step 6** Lift and turn the freespool clutch handle to the Disengage position (See FIGURE 12). Pull 5 feet of wire rope off the drum. Return the freespool clutch handle back to Engaged position. Activate the Winch cable in and out by momentarily pressing the handheld pendant switch to check drum rotation direction. The switch is labeled "IN" for winching in and "OUT" for winching out. When released the switch will automatically go to the off position. **IF THIS DOES NOT OCCUR THEN REMOVE THE HAND HELD PLUG FROM THE RECEPTACLE.**

If the drum rotates in the wrong direction then check the trouble shooting area in this manual or call for assistance 800-533-7372. or contact winches@hamptonproducts.com

- Step 7** You are now ready to winch. Practice winching operations by freespooling cable out and winching in under low loads. Make sure all wraps are wound on tight and close against the previous wrap. Plan some tests in advance and learn to watch and listen. Recognize the sound of a light steady pull, a heavy pull and sounds caused by load jerking or shifting. You will gain confidence. **ALWAYS WEAR SAFETY GLASSES, LEATHER GLOVES AND USE THE HAND SAVER STRAP (FIGURE 4).**

## Pendant Operation

The handheld pendant switch activates a solenoid that activates power to the winch motor.

To connect the handheld pendant switch, remove the cover on the plug receptacle and insert the plug end of remote switch (See FIGURE 10). The plug on the pendant control cord is keyed and will fit into the socket only one way.

The switch trigger returns to the "Off" position when released. To change direction, move the toggle in the other direction. (See FIGURE 10).

The red push button activates the LED work light.

FIGURE 10

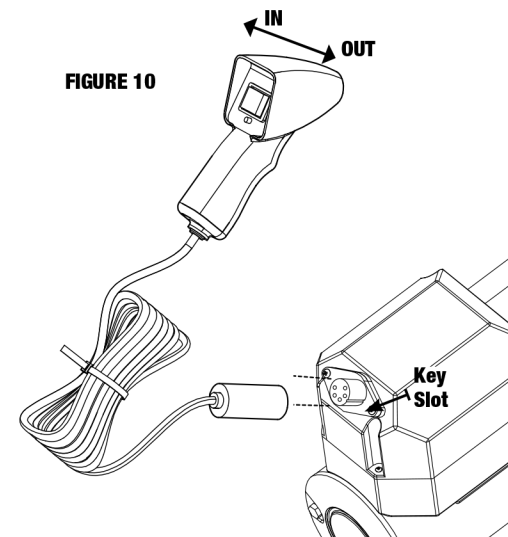

### CAUTION

The switch assembly must be kept free of dirt and moisture to ensure safe operation.

## Wireless Operation (Remote KTA14126)

Plug the receiver into the five pin plug located on the winch control box (Where the hand held control usually plugs into). Please take care to line up the keyed notch on the inside of the receiver with the keyway on the outside of the plug (See FIGURE 11). You are now ready to remotely operate the winch.

Make sure notch fits into key way as misalignment will damage the unit and void warranty.

Please note that the unit is programmed for a 1 second delay in both starting and stopping. **This may represent a 6" to 8" travel in the wire rope.**

Your wireless remote is now installed. Enjoy your wireless remote switch winching experience.

FIGURE 11

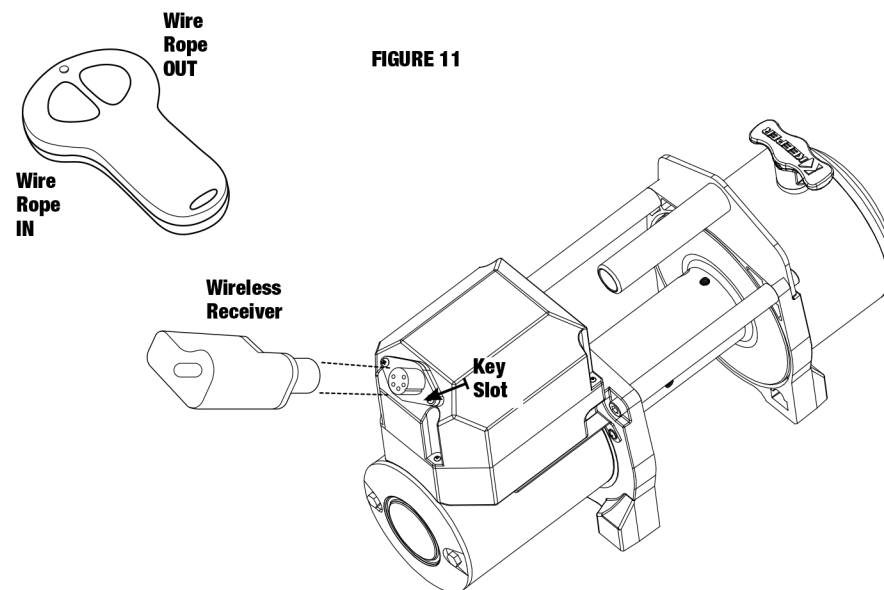

Operation Instructions for KTA14126 Wireless Remote  
Mode d'Emploi de la Télécommande KTA14126  
Instrucciones de Funcionamiento para Control Remoto Inalámbrico KTA14126

Wireless remote operation • Fonctionnement de la télécommande • Funcionamiento de control remoto inalámbrico

Your wireless remote will operate the winch from up to 100+ feet depending on weather conditions as rain, snow or fog can shorten the distance.

1. To activate the sender PRESS BOTH the "Winch In" (A) (Arrow towards the winch drum) and "Winch Out" (B) (Arrow facing away from the drum) buttons at the same time for 5 seconds or until the indicator light (C) turns red. Refer to **Fig.1**

2. Plug the receiver (**Fig. 2**) into the female plug receptacle on the top of the solenoid box on the winch (Same place you would normally plug your handheld switch control) **Fig. 3**

3. You are now ready to winch. When you press either the "Winch In" or "Winch Out" buttons the red indicator light (C) will flicker.

**PLEASE NOTE** – If the switch is not used for 5 minutes it will go into sleep mode for safety and also extend battery life. To revive the sender you will need to repeat step 1.

La télécommande fait fonctionner le treuil dans un rayon de 33+ mètres (100+ pieds) selon les conditions météorologiques telles que pluie, neige ou brouillard qui peuvent raccourcir la distance de réception des signaux.

1. Pour activer l'émetteur, APPUYER EN MÊME TEMPS sur les boutons (A) « Winch In » (Treuil – enroulement) (flèche pointant vers le tambour de treuil) et (B) « Winch Out » (Treuil – déroulement) (flèche orientée vers le côté opposé au treuil) pendant 5 secondes ou jusqu'à ce que l'indicateur lumineux (C) devienne rouge. Voir la **Fig. 1**

2. Enfiler le récepteur (**Fig. 2**) sur la prise femelle située au sommet du boîtier de la bobine (solenóide) du treuil (même endroit où brancher normalement la commande d'interrupteur manuelle) **Fig. 3**

3. Le treuil est alors prêt à fonctionner. L'indicateur lumineux rouge (C) clignote lorsqu'on appuie sur le bouton « Winch In » (Treuil – enroulement) ou sur le bouton « Winch Out » (Treuil – déroulement).

**REMARQUE IMPORTANTE** – Quand la commande d'interrupteur reste inutilisée pendant 5 minutes elle passe en mode de veille pour raisons de sécurité et de conservation des piles. Pour réactiver l'émetteur, il faut répéter l'étape 1.

Su control remoto inalámbrico hará funcionar el cabrestante desde una distancia hasta de más de 33 m (100 pies o más); dependiendo de las condiciones del tiempo, tales como lluvia, nieve o neblina, la distancia puede acortarse.

1. Para activar el emisor PULSE AMBOS botones de "Enrollar cabrestante" (A) (Flecha hacia el tambor del cabrestante) y de "Desenrollar cabrestante" (B) (Flecha en dirección opuesta al tambor) a la misma vez durante cinco (5) segundos o hasta que la lámpara indicadora (C) se ilumine en color rojo. Consulte la **Fig. 1**.

2. Enchufe el receptor (**Fig.2**) en el receptáculo hembra de enchufe situado en la parte superior de la caja de solenoides en el cabrestante (el mismo lugar donde usted normalmente enchufaría su control de conmutación manual) - **Fig. 3**.

3. Usted ahora está listo para hacer funcionar el cabrestante. Cuando usted pulse ya sea el botón de "Enrollar cabrestante" o el botón de "Desenrollar cabrestante, la lámpara indicadora roja se iluminará intermitentemente.

**SÍRVASE TOMAR NOTA** – si el conmutador no se utiliza durante cinco (5) minutos, pasará al modo de suspensión como medida de seguridad y para extender la vida de servicio de la pila. Para revivir al emisor, usted necesita repetir el paso 1.

©2013 Hampton Products International Corp.  
50 Icon, Foothill Ranch, CA 92610  
800-533-7372  
www.hamptonproducts.com  
www.keeperwinches.com  
999-01001\_Rev32113

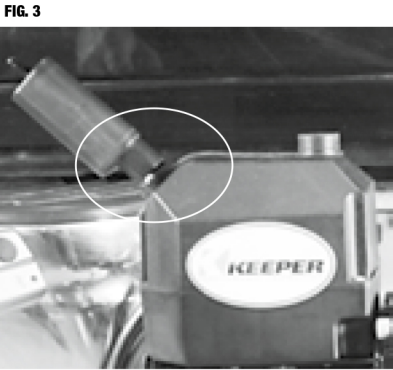
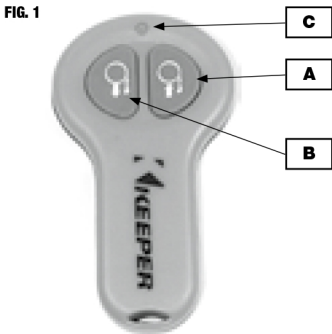

Operation Instructions for KTA14126 Wireless Remote  
Mode d'Emploi de la Télécommande KTA14126  
Instrucciones de Funcionamiento para Control Remoto Inalámbrico KTA14126

Reprogramming senders to a receiver  
Reprogrammation des émetteurs vers un récepteur  
Cómo reprogramar emisores para un receptor

If you ever have to replace your senders or receiver you can program the new units to function with the old units by following the procedure below.

1. Unscrew and remove the two metal screws at the plug side of the receiver. **Fig. 4**

2. Gently pull out the receiving assembly. **Fig. 5**

3. **MAKE SURE THE WINCH IS IN THE FREEWHEEL POSITION**

4. Plug the assembly into the female plug receptacle on top of the winch solenoid control box. The same position as shown in **Fig 3**.

5. Push down on the Smart Button. **Fig 6**

6. As the Smart Button is depressed, first push the "Winch Out" (B in **Fig.1**) button in for at least 2 seconds before releasing and then push the "Winch In" (A in **Fig. 1**) button in for two seconds before releasing. The movement of the motor will indicate that you have successfully reprogrammed the senders.

7. Once you have determined that the units are working, unplug the receiving assembly from the control box and carefully slide it back into the housing and secure it with the two screws.

8. You are ready to use the reprogrammed Wireless. \*\*Remember that your winch is in the freewheel position.



FIG. 4

S'il est nécessaire de remplacer les émetteurs ou le récepteur, il est possible de reprogrammer les nouvelles unités pour qu'elles fonctionnent avec les unités anciennes, en suivant la procédure ci-dessous.

1. Dévisser et enlever les deux vis métalliques côté fiche du récepteur. **Fig. 4**

2. Tirer délicatement sur l'ensemble de récepteur. **Fig. 5**

3. **VÉRIFIER QUE LE TREUIL EST EN POSITION NEUTRE (ROUE LIBRE)**

4. Enfiler l'ensemble sur la prise femelle située au sommet du boîtier de la bobine de commande du treuil. Même position que l'illustration de la **Fig 3**.

5. Appuyer sur le Bouton intelligent. **Fig 6**

6. Quand le Bouton intelligent est enfoncé, appuyer d'abord sur le bouton « Winch Out » (Treuil – déroulement) (B de la **Fig. 1**) pendant au moins 2 secondes avant de le relâcher, puis enfoncer le bouton « Winch In » (Treuil – enroulement) (A de la **Fig. 1**) pendant 2 secondes avant de le relâcher. Le mouvement du moteur indique que la programmation des émetteurs est réussie.

7. Quand le bon fonctionnement des unités a été vérifié, débrancher l'ensemble de récepteur du boîtier de commande et le replacer délicatement dans l'enceinte en l'y faisant glisser et le fixer avec les deux vis.

8. La télécommande reprogrammée est alors prête à l'emploi. \*\*Il faut se rappeler que le treuil est en position neutre (roue libre)



FIG. 5

Si en alguna ocasión usted tuviera que reemplazar sus emisores o receptor, usted puede programar las nuevas unidades para que funcionen con las unidades antiguas al seguir el siguiente procedimiento dado abajo.

1. Desatornille y desmonte los dos tornillos de metal situados en el lado de enchufe del receptor - **Fig. 4**.

2. Jale cuidadosamente el ensamblaje receptor - **Fig. 5**.

3. **ASEGÚRESE QUE EL CABRESTANTE SE ENCUENTRE EN LA POSICIÓN DE GIRO LIBRE**

4. Enchufe el ensamblaje en el receptáculo hembra de enchufe situado sobre la parte superior de la caja de control de solenoides del cabrestante. La misma posición tal como se muestra en la **Fig. 3**.

5. Pulse sobre el "Botón inteligente" – **Fig. 6**.

6. Mientras se tiene pulsado el Botón inteligente, primero pulse el botón de "Desenrollar cabrestante" (B en la **Fig. 1**) durante cuando menos dos (2) segundos antes de soltarlo, y luego pulse el botón de "Enrollar cabrestante" (S en la **Fig. 1**) durante cuando menos dos (2) segundos antes de soltarlo. El movimiento del motor le indicará que usted ha reprogramado exitosamente los emisores.

7. Una vez que haya determinado que las unidades están funcionando, desenchufe el ensamblaje receptor de la caja de control y deslícelo con cuidado otra vez dentro de la carcasa y asegúrelo con los dos tornillos.

8. Ya está usted listo para usar el Control remoto inalámbrico.

**\*\* Recuerde que su cabrestante está en la posición de giro libre.**

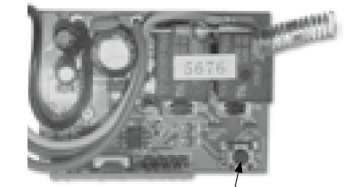

FIG. 6

Smart Button  
Bouton intelligent  
Botón inteligente

©2013 Hampton Products International Corp.  
50 Icon, Foothill Ranch, CA 92610  
800-533-7372  
www.hamptonproducts.com  
www.keeperwinches.com  
999-01001\_Rev32113



## Freespool Operation

1. Lift and rotate the clutch lever to the “Disengaged” position as shown in **Figure 12**. If there is a load on the wire rope, the clutch lever may not turn easily. **DO NOT FORCE THE CLUTCH LEVER.** Release tension on the wire rope by jogging out some of the wire rope, then try releasing the clutch.
2. Pull out the wire rope and secure to anchor or load.
3. Check that there are at least five (5) wraps of wire rope left on the drum.
4. Re-engage the drum by lift and rotating the clutch lever to the “Engaged” position, apply power to engage clutch (see **Figure 12**).

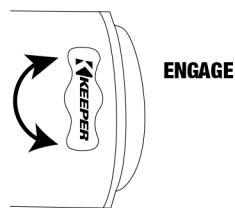

FIGURE 12



**CAUTION**  
Lever must be in the engaged position and locked before winching.

## Brake Operation

Your winch incorporates an automatic load holding brake. After winching in a load, this mechanism holds the load, up to the rated capacity of the winch. While powering out the load, the winch controls the rate of speed by applying the brake in proportion to the amount of the load in the winch cable. This results in heavier loads powering-out more slowly than lighter loads.

Similar to the friction-type brakes in your automobile which can generate heat if used for a long period of time, the winch brake can generate heat if used to power-out a load for a long period of time.

**To ensure optimum winch performance, always limit powering-out a load to 2 minutes and allow the brake to cool for 15 minutes before continuing to winch.**

Under normal use, the brake mechanism should not require any adjustment. Should the brake fail to hold a load or maintain a constant rate of speed during power-out operation, the brake spring may be worn and require replacement.

FOR PARTS INFORMATION PLEASE CHECK [www.keeperwinches.com](http://www.keeperwinches.com),  
[winches@hamptonproducts.com](mailto:winches@hamptonproducts.com), OR CALL CUSTOMER SERVICE 1-877-533-7372

## Extending the Life of Your Winch

1. **KEEP A TIGHTLY WOUND WIRE ROPE DRUM.** Keep the wire rope tightly and evenly wound on the drum all the time. Do not allow the wire rope to become loosely wound. A loosely wound drum allows a wire rope under load to work its way down into the layers of wire rope on the drum. When this happens, the wire rope may become wedged within the body of the windings damaging the wire rope. A good practice is to rewind the wire rope under tension after each use. Apply tension using hand saver strap (**FIGURE 3**) and ALWAYS wear safety glasses and leather gloves.
2. **DO NOT ALLOW WINCH MOTOR TO OVERHEAT.** Keep the duration of pulls as short as possible. If the motor becomes uncomfortably hot by touching, stop winching and allow the motor to cool down.  
**KEEP THE VEHICLE ENGINE RUNNING TO RECHARGE THE BATTERY** during the cooling break.
3. **USE A PULLEY BLOCK FOR HEAVY LOADS.** To maximize Winch and wire rope life, use a pulley block (not included) to double line heavier loads. (See **FIGURE 3**) (See [www.TRACKERwinch.com](http://www.TRACKERwinch.com) for part number **KWA14550**) For maximum performance use pulley block is load is greater than 75% of the rated capacity of the winch. For the KW7.5RM use a pulley block once you exceed 5,600 lbs. Always use a pulley block (part number **KWA14550**) that is rated twice the capacity of the winch.



**CAUTION** If the winch motor stalls, do not continue to apply power.

4. The pull required to start a load moving is often much greater than the pull required to keep it moving.  
**AVOID FREQUENT STOPS AND STARTS DURING THE PULL.**

5. **PREVENT KINKS IN WIRE ROPE BEFORE THEY OCCUR (FIGURE 13).**

- a. This is the start of a kink. Wire rope should be straightened.
- b. Wire rope was pulled and loop has tightened into a kink. Wire rope is now permanently damaged and **MUST** be replaced.
- c. Result of kinking is that each strand pulls a different amount causing strands under greatest tension to break and reduce load capacity of wire rope. The wire rope **MUST** be replaced. Use only genuine Keeper Winch replacement part number **KWA14613 72' X 5/16"**

Contact: [winches@hamptonproducts.com](mailto:winches@hamptonproducts.com) to order.

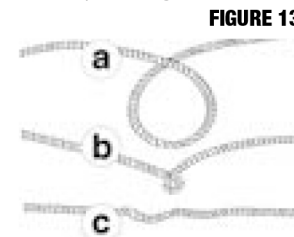

FIGURE 13

## Replacing The Wire Rope



**WARNING**  
Never Substitute a heavier or lighter wire rope. Never use rope made of any other materials other than wire.  
Use only recommended Keeper replacement wire rope, 72' x 5/16" **KWA14613**.

Attach wire rope to the drum using screw provided (**FIGURE 14**).

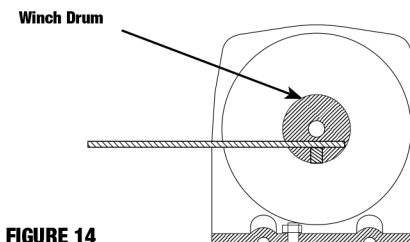

FIGURE 14

## Maintenance & Repair



**WARNING**  
Before each use, check mounting bolts for tightness, inspect cable for damage. Inspect remote control assembly for any damage. Periodically use a clean, dry towel to remove dirt and debris from winch housing.

**Lubrication:** The gear box is permanently lubricated. Do not attempt to disassemble the gear box. This will void your warranty.



## Troubleshooting

If a problem arises, **DO NOT RETURN TO RETAILER** call Keeper® Winch Customer Service at 800-533-7372 or e-mail [winches@hamptonproducts.com](mailto:winches@hamptonproducts.com).

Symptom	Possible Causes	Corrective Action
<b>Motor will not operate or runs in one direction only</b>	<ol style="list-style-type: none"> <li>1. Broken wires or bad battery connection</li> <li>2. Switch inoperative</li> <li>3. Damaged winch</li> <li>4. Damaged solenoid</li> <li>5. Circuit breaker malfunction</li> </ol>	<ol style="list-style-type: none"> <li>1. Check for poor connection(s) and that all wiring is tight and clean</li> <li>2. Check that switch wires are connected properly to the solenoid</li> <li>3. Replace or repair</li> <li>4. Replace solenoid</li> <li>5. Replace circuit breaker</li> </ol>
<b>Motor runs extremely hot</b>	<ol style="list-style-type: none"> <li>1. Long period of operation</li> <li>2. Damaged during operation</li> </ol>	<ol style="list-style-type: none"> <li>1. Allow to cool</li> <li>2. Replace or repair</li> </ol>
<b>Motor runs but with insufficient power or line speed</b>	<ol style="list-style-type: none"> <li>1. Weak/Low battery</li> <li>2. Battery to Winch wire too long</li> <li>3. Poor battery connection</li> <li>4. Poor ground</li> <li>5. Damaged motor</li> </ol>	<ol style="list-style-type: none"> <li>1. Recharge or replace battery. Check charging system.</li> <li>2. Use only supplied wires. If increase in length is needed, drop down wire size to 2 or 3 AWG.</li> <li>3. Check battery terminals for corrosion. Clean as required.</li> <li>4. Check and clean connections</li> <li>5. Replace or repair</li> </ol>
<b>Motor runs but drum does not turn</b>	Clutch not engaged	Engage clutch
<b>Winch runs backwards</b>	<ol style="list-style-type: none"> <li>1. Battery wires reversed</li> <li>2. Switch wires reversed</li> <li>3. Switch installed incorrectly</li> </ol>	<ol style="list-style-type: none"> <li>1. Recheck wiring</li> <li>2. Recheck wiring</li> <li>3. Check switch installation</li> </ol>

**LIMITED LIFETIME WARRANTY:** Hampton Products International Corporation warrants product according to provisions below: Mechanical components are warranted for lifetime of the winch to be free from defects of material and workmanship. Electrical components are warranted for 1 year to be free from defects of material or workmanship. If a defect in material or workmanship occurs, call 800-533-7372 for instructions on how to have the Product repaired or replaced. This Warranty applies only to the original Purchaser/Consumer of the Products from the date of purchase of the Product. Defective Products returned become property of the manufacturer. Limitations on the Warranty: The following limitations apply to the Warranty: (a) The Warranty applies only to Products which are defective in material or workmanship. This Warranty does not cover normal wear and tear. The Warranty does not cover service or labor charges which are incurred in removing or replacing any Product. (b) The Warranty does not cover the winch finish or wire rope. Accordingly, the manufacturer will not replace, repair or refinish any Products if the finish on the Product is worn in any manner. (c) The Warranty does not extend to Products which are damaged or which fail as a result of the Product being abused, neglected, or misused in any manner, or as a result of any accident, or which are misapplied, overloaded, improperly installed, or altered in any manner by anyone other than the manufacturer its agents or representatives.

**Obligations of Purchaser/Consumer.** To obtain the benefits of the Warranty, The Purchaser/Consumer must return the defective Product(s), freight prepaid together with proof of purchase within the warranty period from the date of purchase to Hampton Products or an authorized service center.

**Legal Rights and Limitations of Purchaser/Consumer.** **THIS WARRANTY GIVES YOU SPECIFIC LEGAL RIGHTS AND YOU ALSO MAY HAVE OTHER RIGHTS WHICH VARY FROM STATE TO STATE. ANY IMPLIED WARRANTY OF MERCHANTABILITY OR FITNESS FOR A PARTICULAR PURPOSE ON ANY PRODUCT SHALL BE LIMITED TO TERMS OF WARRANTY FROM THE DATE OF PURCHASE AT RETAIL TO THE ORIGINAL PURCHASER. SOME STATES DO NOT ALLOW LIMITATIONS.**

Hampton Products International Corp.  
 50 Icon  
 Foothill Ranch, CA 92610 USA  
 800-533-7372  
[www.keeperwinches.com](http://www.keeperwinches.com) or [winches@hamptonproducts.com](mailto:winches@hamptonproducts.com)

**THIS PRODUCT IS NOT INTENDED FOR LIFTING / HOISTING**