

**Basic Data**

**Suitable for**

Concrete, stone, low density concrete, expanded clay, hollow blocks, hollow bricks, solid bricks and plasterboard.

**Applications**

For all types of through installation, such as electrical trunking, switches, battens, clamps and door and window frames.

**Advantages**

- Hammer-in fixing
- Fast installation
- Powerful expansion – large load values
- Complete range for electrical and building work
- Through fixing

**Material**

Plug in PA (polyamide), screws nail in steel.

**Temperature Range**

– 40 to + 80 °C.

**Accessories**

Caps available to cover the nail head.

**Packaging**

Cardboard cation.

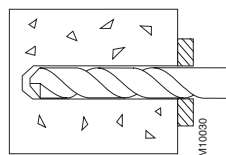

Drill through the fixture straight into the base material. Use drill size in accordance with the table.

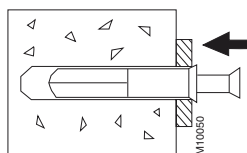

Clean the hole and install the plug.

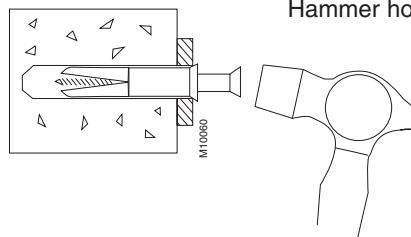

Hammer home.

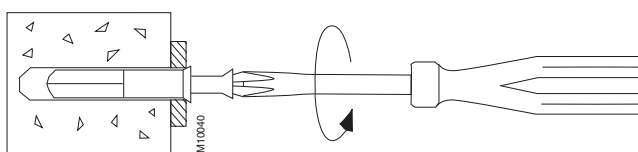

Easy to remove: Unscrew the screw-nail.

# Nail Plug TPS

Range	Type Drill Ø/Max. fixture thickness Plug length mm	Colour	Qty/Pack	Art. No.
	<b>Nailplug</b>			
	TPS-4/5×25	Clear	100	1149 301 EA947A-1
	TPS-4/15×35	Clear	100	1149 350
	TPS-5/5×35	Clear	100	1149 608 EA947A-2
	TPS-5/5×35	Black	100	1149 616
	TPS-5/5×35	Brown	100	1149 624
	TPS-5/20×50	Clear	100	1149 707
	TPS-5/20×50	Black	100	1149 715
	TPS-6/5×35	Clear	100	1150 002 EA947A-4
	TPS-6/5×35	Black	100	1150 010
	TPS-6/20×50	Clear	100	1150 051 EA947A-5
	TPS-6/45×75	Clear	100	1150 101
	TPS-8/15×50	Clear	50	1150 150
	TPS-8/40×75	Clear	50	1150 200
	TPS-8/65×100	Clear	50	1150 259
	TPS-8/85×120	Clear	50	1150 281
	TPS-10/20×75	Clear	50	1150 309
	TPS-10/60×115	Clear	50	1150 358
	<b>Cap</b>			
TPS-H5	White	100	1150 903	
TPS-H6	White	100	1150 929	
TPS-H8	White	100	1150 945	
TPS-H10	White	50	1150 960	

Technical data (1 kN = 100 kg)								
Type Drill Ø max. fixture thick- ness x plug length mm	Plug Ø mm	Screw- nail Ø mm	Min. drill depth incl. fixture mm	Max thickness of fixture mm	Recommended load Shear/pull-out <sup>1)</sup>			
					Concrete K 25 kN	Solid brick kN	Low density concrete (500 grade) and expanded clay kN	
TPS-4/5×25	4	2.5	30	5	0.15/0.05	0.15/0.05	–	
TPS-4/15×35	4	2.5	40	15	0.15/0.05	0.15/0.05	–	
TPS-5/5×35	5	3	42	5	0.3/0.1	0.3/0.1	–	
TPS-5/20×50	5	3	57	20	0.3/0.1	0.3/0.1	–	
TPS-6/5×35	6	3.5	42	5	0.4/0.2	0.4/0.2	0.1/0.07	
TPS-6/20×50	6	3.5	57	20	0.4/0.2	0.4/0.2	0.1/0.07	
TPS-6/45×75	6	3.5	82	45	0.4/0.2	0.4/0.2	0.1/0.07	
TPS-8/15×50	8	4	62	15	0.65/0.3	0.5/0.25	0.2/0.13	
TPS-8/40×75	8	4	87	40	0.65/0.3	0.5/0.25	0.2/0.13	
TPS-8/65×100	8	4	112	65	0.65/0.3	0.5/0.25	0.2/0.13	
TPS-8/85×120	8	4	132	85	0.65/0.3	0.5/0.25	0.2/0.13	
TPS-10/20×75	10	7	90	20	1.7/1.4	1.7/0.7	0.7/0.4	
TPS-10/60×115	10	7	130	60	1.7/1.4	1.7/0.7	0.7/0.4	

<sup>1)</sup> Safety factor for shear 4.5 and for pull-out, 6.