

EA948BJ-21~-55 [ステンレス製] 取手



EA948BJ-21~-35



EA948BJ-41~-55

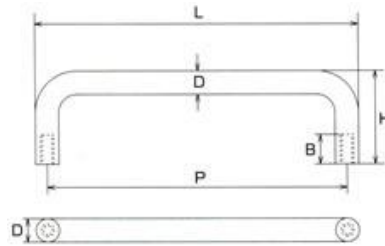

雌ねじ

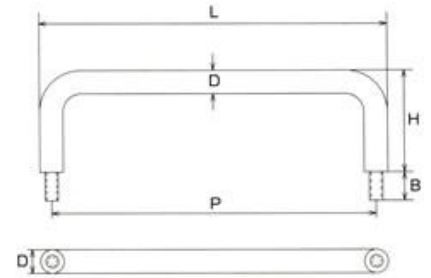

雄ねじ



- ・材質…SUS304[鏡面仕上]
- ・付属品…六角ナット、
スプリングワッシャー(各2個付):-41~-55のみ

(雌ねじ)

| 品番 | サイズ(mm) | | | | | | 重量(g) | 参考使用荷重 | |
|------------|---------|-----|-----|----|------|-----|-------|--------|------|
| | D | L | P | H | B | ネジ径 | | (kgf) | (kN) |
| EA948BJ-21 | 6 | 46 | 40 | 23 | 7 | M4 | 14 | 20 | 0.20 |
| EA948BJ-22 | 6 | 66 | 60 | 23 | 7 | M4 | 18 | 20 | 0.20 |
| EA948BJ-23 | 6 | 86 | 80 | 30 | 7 | M4 | 26 | 20 | 0.20 |
| EA948BJ-24 | 7 | 75 | 68 | 30 | 8 | M5 | 30 | 45 | 0.44 |
| EA948BJ-25 | 8 | 98 | 90 | 30 | 8 | M5 | 48 | 45 | 0.44 |
| EA948BJ-26 | 8 | 108 | 100 | 40 | 8 | M5 | 61 | 45 | 0.44 |
| EA948BJ-27 | 8 | 118 | 110 | 40 | 8 | M5 | 63 | 45 | 0.44 |
| EA948BJ-28 | 8 | 128 | 120 | 40 | 8 | M5 | 67 | 45 | 0.44 |
| EA948BJ-29 | 10 | 110 | 100 | 50 | 8 | M6 | 105 | 60 | 0.59 |
| EA948BJ-30 | 10 | 120 | 110 | 50 | 8 | M6 | 112 | 60 | 0.59 |
| EA948BJ-31 | 10 | 130 | 120 | 50 | 8 | M6 | 118 | 60 | 0.59 |
| EA948BJ-32 | 12 | 162 | 150 | 50 | 12.5 | M8 | 181 | 75 | 0.74 |
| EA948BJ-33 | 12 | 212 | 200 | 50 | 12.5 | M8 | 226 | 75 | 0.74 |
| EA948BJ-34 | 12 | 262 | 250 | 50 | 12.5 | M8 | 269 | 75 | 0.74 |
| EA948BJ-35 | 12 | 312 | 300 | 50 | 12.5 | M8 | 314 | 75 | 0.74 |

(雄ねじ)

| 品番 | サイズ(mm) | | | | | | 重量(g) | 参考使用荷重 | |
|------------|---------|-----|-----|----|----|-----|-------|--------|------|
| | D | L | P | H | B | ネジ径 | | (kgf) | (kN) |
| EA948BJ-41 | 6 | 46 | 40 | 23 | 7 | M4 | 19 | 20 | 0.20 |
| EA948BJ-42 | 6 | 66 | 60 | 23 | 7 | M4 | 23 | 20 | 0.20 |
| EA948BJ-43 | 6 | 86 | 80 | 30 | 7 | M4 | 30 | 20 | 0.20 |
| EA948BJ-44 | 7 | 75 | 68 | 30 | 11 | M5 | 39 | 45 | 0.44 |
| EA948BJ-45 | 8 | 98 | 90 | 30 | 11 | M5 | 57 | 45 | 0.44 |
| EA948BJ-46 | 8 | 108 | 100 | 40 | 11 | M5 | 68 | 45 | 0.44 |
| EA948BJ-47 | 8 | 118 | 110 | 40 | 11 | M5 | 72 | 45 | 0.44 |
| EA948BJ-48 | 8 | 128 | 120 | 40 | 11 | M5 | 76 | 45 | 0.44 |
| EA948BJ-49 | 10 | 110 | 100 | 50 | 11 | M6 | 119 | 60 | 0.59 |
| EA948BJ-50 | 10 | 120 | 110 | 50 | 11 | M6 | 124 | 60 | 0.59 |
| EA948BJ-51 | 10 | 130 | 120 | 50 | 11 | M6 | 132 | 60 | 0.59 |
| EA948BJ-52 | 12 | 162 | 150 | 50 | 20 | M8 | 218 | 75 | 0.74 |
| EA948BJ-53 | 12 | 212 | 200 | 50 | 20 | M8 | 262 | 75 | 0.74 |
| EA948BJ-54 | 12 | 262 | 250 | 50 | 20 | M8 | 305 | 75 | 0.74 |
| EA948BJ-55 | 12 | 312 | 300 | 50 | 20 | M8 | 350 | 75 | 0.74 |