

# HEAVY DUTY DOOR HINGE, EQUAL

**316 STAINLESS STEEL**

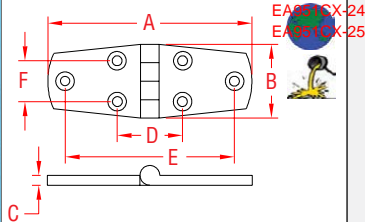

ITEM	A	B	C	D	E	F	WT
	(length)						(lb)
S3822-0075	3"	1.47"	0.19"	1.12"	2.35"	0.80"	0.21
S3822-0100	4"	1.47"	0.17"	1.34"	3.44"	0.82"	0.26

**NOTE:**  
**USE 6 #10 FASTENERS.**

**HEAVY DUTY HINGE WITH PRECISION CAST COMPONENTS.  
PIN IS STAINLESS AND WELDED ON ONE SIDE TO PREVENT  
IT FROM WORKING LOOSE.**

**REFERENCE "FASTENER MATCHING CHART" (PAGE 159)  
FOR COMPATIBLE FASTENERS.**