

Electro-magnets

Energise to hold

Electric current required to turn the magnet ON.

Power is removed to turn the magnet OFF.

Sturdy bright nickel plated cylinder, passivated with body mounting.

High-quality permeable iron for low remanence.

Armature plates to suit.

Operating voltage 12VDC, 24VDC & 240VAC (with rectified plug connector)

Connector options Flying leads, two-pole connector and Hirschman connector

Mountings Threaded holes in magnet rear face

Finish Bright nickel plated with machined face

ED rating 100%

IP rating 54 (20 for the two-pole connector)



Two-pole connector

Standard operating voltage

20
25
30
40
50
65
80
100

Product no.	Current mA	Product no.	Current mA	Air gap mm										
				Pull force (+/- 10%) N										
				0	0.09	0.18	0.27	0.36	0.59	1.00	1.59	2.00	4.00	
M52180/24VDC	100	M52180/12VDC	210	53	22	9	5	3	2	1	-	-	-	-
EA984CM-1 M52172/24VDC	90	M52172/12VDC	180	150	51	22	12	8	4	2	-	-	-	-
EA984CM-2 M52173/24VDC	140	M52173/12VDC	280	280	149	80	43	26	12	5	2	2	-	-
EA984CM-3 M52174/24VDC	230	M52174/12VDC	440	550	276	144	83	57	30	14	7	5	3	-
EA984CM-4 M52175/24VDC	240	M52175/12VDC	470	1000	655	442	282	187	87	37	24	19	6	-
EA984CM-5 M52176/24VDC	340	M52176/12VDC	690	1670	1137	792	533	347	180	78	39	23	11	-
M52183/24VDC	580	M52183/12VDC	1116	2000	1560	1117	715	567	283	130	6.7	3.7	2	-
M52184/24VDC	940	M52184/12VDC	1850	3600	2790	2230	1610	1360	1340	470	260	150	60	-

20, 25, 30mm diameter
Free leads (500mm long)

Leads: 1 red, 1 black
0.3mm square x 500mm long

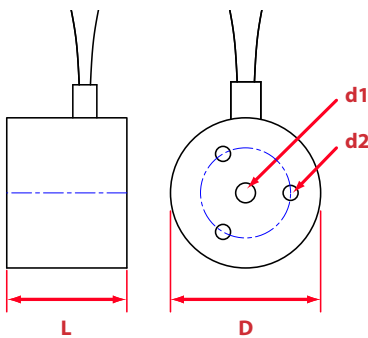

40, 50, 65, 80, 100mm diameter,
12VDC & 24VDC
Two-pole connector

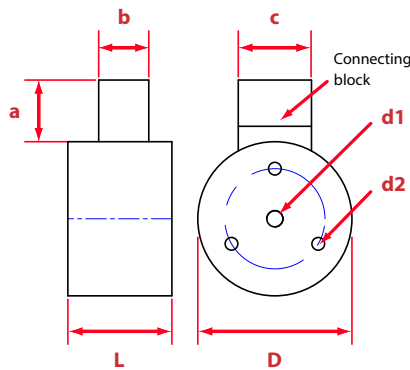

50, 65mm diameter 240VAC
Hirschman connector

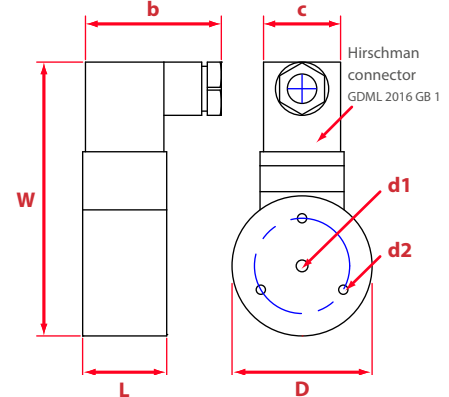

Product no.	Dimension										PCD mm	Weight g
	D	L	W	a	b	c	d1	d2				
12V and 24V units	mm											
M52180/----	20	18	-	-	-	-	M4	M3	14	36		
M52172/----	25	20	-	-	-	-	M4	M3	15	66		
M52173/----	30	24	-	-	-	-	M5	M3	18	108		
M52174/----	40	27	-	16	13	19	M5	M4	26	210		
M52175/----	50	30	-	16	13	19	M5	M4	34	364		
M52176/----	65	35	-	16	13	19	M8	M5	40	710		
M52183/----	80	38	-	16	13	19	M8	M6	50	1203		
M52184/----	100	43	-	16	13	19	M10	M6	75	2200		
240V units	mm											
M52175/240VA	50	30	98	-	50	30	M5	M4	34	408		
M52176/240VA	65	35	111	-	50	30	M8	M5	40	744		