

EA986GG-15



EAN: 4047526224899

ID: 224899

Light duty swivel castor with top plate fitting, Wheel with solid rubber tyres, with synthetic rim

Bracket:

Made of pressed steel, with double ball bearing in the swivel head, strong central kingpin, ball protection by the special top plate and ball disc design. The special Blickle dynamic riveting process of the swivel head results in minimal swivel head play and smooth rolling characteristics with an increased service life achieved by the work hardening of the ball race grooves. Bolted wheel axle. Zinc-plated, blue-passivated, Cr6-free.

Wheels:

Tyre & running tread: Made of high-quality solid rubber, very high operational comfort, low-noise operation, very good floor preservation. Tread colour: black

Rim / wheel centre: Made of high-quality, impact-resistant nylon. Pressed-on tyre.

Variants:

in elektrisch leit-fähiger Ausführung

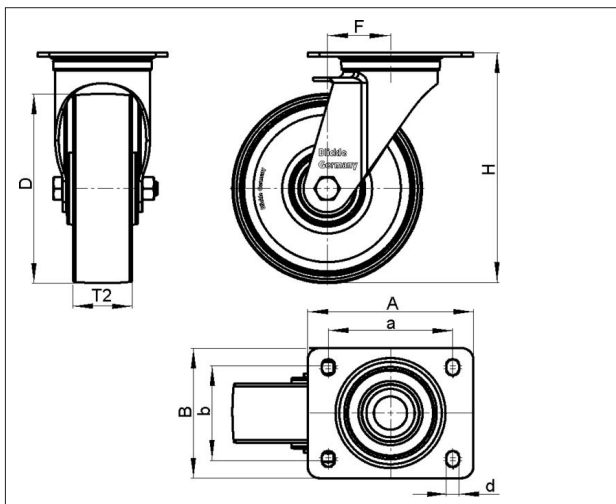

Technical data

Wheel Ø (D)	125 mm
Wheel width (T2)	25 mm
Load capacity	75 kg
Total height (H)	161 mm
Offset swvl castor (F)	40 mm
Unit weight	0.765 kg
Temperature range from	-20 °C
Temperature range to	60 °C
Tread & tyre hardness	80° Shore A
Bearing type	
Plate size (A,B)	90 x 66 mm
Bolt hole Ø (d)	8,5 mm
Bolt hole spacing (a,b)	75x45/61x51 mm

Rolling resistance



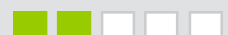

Operating noise



Floor surface preservation



LKPA-VPA 125K-EL

Variants	
	Antistatic version
	With pressed steel thread guard, zinc-plated