

EA986GH-2



EAN: 4047526226992

ID: 226993

Light duty swivel castor with top plate fitting with synthetic brake lever, Wheel with solid rubber tyres, with synthetic rim

Bracket:

Made of pressed steel, with double ball bearing in the swivel head, ball protection by the special top plate and ball disc design. The special Blickle dynamic riveting process of the swivel head results in minimal swivel head play and smooth rolling characteristics with an increased service life achieved by the work hardening of the ball race grooves. Bolted wheel axle. Zinc-plated, blue-passivated, Cr6-free.

Wheels:

Tyre & running tread: Made of high-quality solid rubber, very high operational comfort, low-noise operation, very good floor preservation. Tread colour: dark grey

Rim / wheel centre: Made of high-quality, impact-resistant nylon. Pressed-on tyre.

Variants:

mit Feststeller "stop-fix"

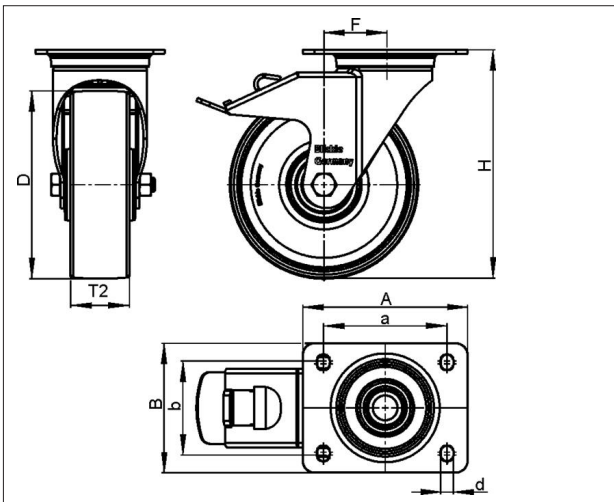

Technical data

Wheel Ø (D)	75 mm
Wheel width (T2)	25 mm
Load capacity	60 kg
Total height (H)	100 mm
Offset swvl castor (F)	29 mm
Unit weight	0.369 kg
Temperature range from	-20 °C
Temperature range to	60 °C
Tread & tyre hardness	80° Shore A
Bearing type	
Plate size (A,B)	60 x 60 mm
Bolt hole Ø (d)	6,2 mm
Bolt hole spacing (a,b)	38x38/48x48 mm

Rolling resistance



Operating noise



Floor surface preservation

