

## EA986HB-100



**EAN: 4047526035556**

**ID: 35550**

**Pressed steel swivel castor, medium heavy duty brackets, with top plate fitting, Wheel with standard solid rubber tyres, with pressed steel rim, reinforced design**

**Bracket:**

Made of pressed steel, with double ball bearing in the swivel head, ball protection by the special top plate and ball disc design. The special Blickle dynamic riveting process of the swivel head results in minimal swivel head play and smooth rolling characteristics with an increased service life achieved by the work hardening of the ball race grooves. Bolted wheel axle. Zinc-plated, blue-passivated, Cr6-free.

**Wheels:**

**Tyre & running tread:** Made of standard solid rubber, very high operational comfort, low-noise operation, very good floor preservation, PAH conform acc. to EU directive 2005/69/EC. Tread colour: black

**Rim / wheel centre:** Pressed steel rim with tubular steel hub, bolted, zinc-plated, blue-passivated, Cr6-free.

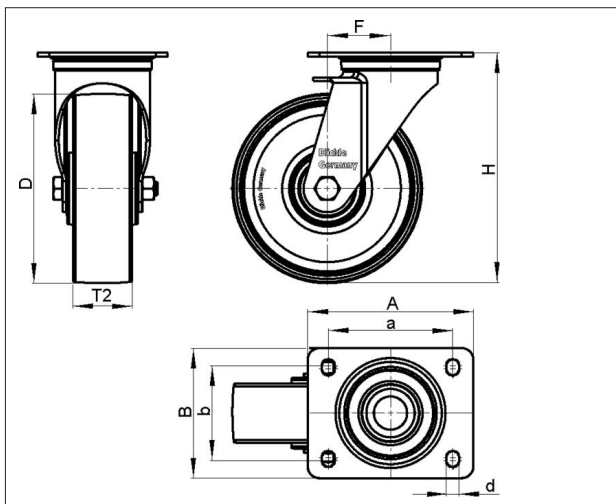

### Technical data

|                         |             |
|-------------------------|-------------|
| Wheel Ø (D)             | 100 mm      |
| Wheel width (T2)        | 30 mm       |
| Load capacity           | 70 kg       |
| Total height (H)        | 125 mm      |
| Offset swvl castor (F)  | 36 mm       |
| Unit weight             | 0.97 kg     |
| Temperature range from  | -25 °C      |
| Temperature range to    | 80 °C       |
| Tread & tyre hardness   | 80° Shore A |
| Bearing type            |             |
| Plate size (A,B)        | 100 x 85 mm |
| Bolt hole Ø (d)         | 9 mm        |
| Bolt hole spacing (a,b) | 80 x 60 mm  |

Rolling resistance



Operating noise



Floor surface preservation



**L-V 100R**

| Variants  |  |
|---|--|
|    | Antistatic version                           |
|    | With pressed steel thread guard, zinc-plated |
|   | With non-marking grey tyre                   |
|  | With 'stop-top' brake                        |