

## EA986HJ-4



**EAN: 4047526562304**

**ID: 562306**

**, Heavy duty wheel with elastic solid rubber tyres  
'Blickle EasyRoll', with welded steel wheel centre**

**Bracket:**

Made of heavy pressed steel, with heavy fork and top plate, very strong bolted and secured central kingpin, double ball bearing in the swivel head, additionally reinforced by the integration of four specially shaped and hardened bearing seats resulting in a very high resistance to shock and impact loads. Bolted wheel axle. Bolted wheel axle. Zinc-plated, blue-passivated, Cr6-free.

**Wheels:**

**Tyre & running tread:** Made of high-quality elastic solid rubber, in smooth rolling quality "Blickle EasyRoll", very high operational comfort, low-noise operation, low rolling resistance, very good floor preservation, vulcanised on the wheel centre. Tread colour: black

**Rim / wheel centre:** Pressed thick-walled steel, triple-welded, with tubular steel hub, lacquered. Vulcanised tyre.

**Variants:**

mit Feststeller "stop-fix"

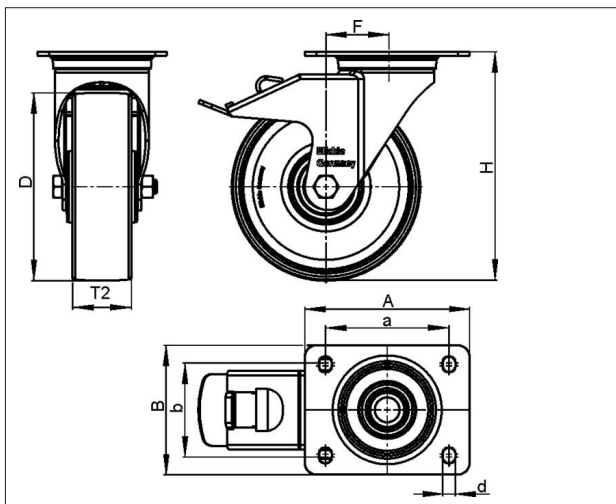

### Technical data

Wheel Ø (D)	200 mm
Wheel width (T2)	50 mm
Load capacity	600 kg
Total height (H)	245 mm
Offset swvl castor (F)	70 mm
Unit weight	5.35 kg
Temperature range from	-25 °C
Temperature range to	80 °C
Tread & tyre hardness	65° Shore A
Bearing type	
Plate size (A,B)	140 x 110 mm
Bolt hole Ø (d)	11 mm
Bolt hole spacing (a,b)	105 x 75-80 mm

Rolling resistance



Operating noise



Floor surface preservation

