

EA986HY-1



EAN: 4047526605896

ID: 605899

**, Heavy duty wheel with elastic solid rubber tyres
'Blickle EasyRoll', with nylon wheel centre**

Bracket:

Made of pressed steel, with double ball bearing in the swivel head, ball protection by the special top plate and ball disc design. The special Blickle dynamic riveting process of the swivel head results in minimal swivel head play and smooth rolling characteristics with an increased service life achieved by the work hardening of the ball race grooves. Bolted wheel axle. Zinc-plated, blue-passivated, Cr6-free.

Wheels:

Tyre & running tread: Made of high-quality elastic solid rubber, in smooth rolling quality "Blickle EasyRoll", very high operational comfort, low-noise operation, low rolling resistance, very good floor preservation, vulcanised on the wheel centre. Tread colour: black

Rim / wheel centre: Made of high-quality, impact-resistant nylon. Vulcanised tyre.

Variants:

mit Feststeller "stop-fix"

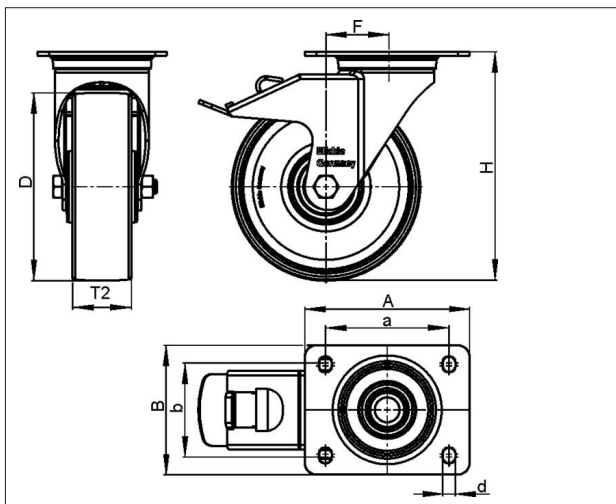

Technical data

Wheel Ø (D)	80 mm
Wheel width (T2)	32 mm
Load capacity	140 kg
Total height (H)	102 mm
Offset swvl castor (F)	38 mm
Unit weight	0.669 kg
Temperature range from	-25 °C
Temperature range to	80 °C
Tread & tyre hardness	65° Shore A
Bearing type	
Plate size (A,B)	100 x 85 mm
Bolt hole Ø (d)	9 mm
Bolt hole spacing (a,b)	80 x 60 mm

Rolling resistance



Operating noise



Floor surface preservation

