

EA986JE-200



EAN: 4047526257682

ID: 257683

Pressed steel swivel castor, medium heavy duty brackets, with top plate fitting, Heavy duty wheel with elastic solid rubber tyres 'Blickle EasyRoll', with aluminium wheel centre

Bracket:

Made of heavy pressed steel, with double ball bearing in the swivel head, strong central kingpin, swivel head seals. The special Blickle dynamic riveting process of the swivel head results in minimal swivel head play and smooth rolling characteristics with an increased service life achieved by the work hardening of the ball race grooves. Bolted wheel axle. Zinc-plated, blue-passivated, Cr6-free.

Wheels:

Tyre & running tread: Made of high-quality elastic solid rubber, in smooth rolling quality "Blickle EasyRoll", very high operational comfort, low-noise operation, low rolling resistance, very good floor preservation, vulcanised on the wheel centre. Tread colour: black

Rim / wheel centre: Made of die-cast aluminium. Vulcanised tyre.

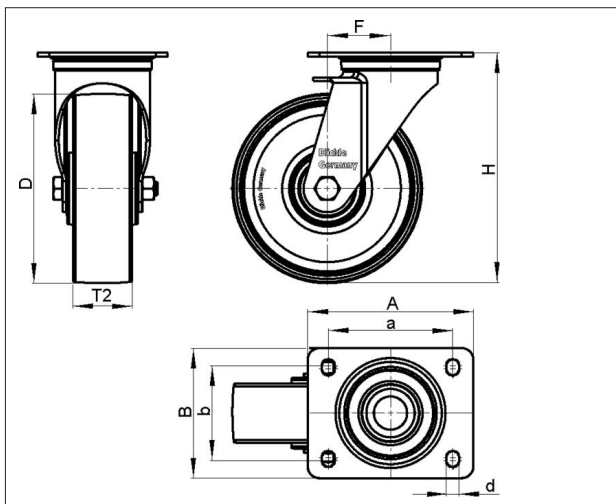

Technical data

Wheel Ø (D)	200 mm
Wheel width (T2)	50 mm
Load capacity	500 kg
Total height (H)	245 mm
Offset swvl castor (F)	65 mm
Unit weight	3.558 kg
Temperature range from	-25 °C
Temperature range to	80 °C
Tread & tyre hardness	65° Shore A
Bearing type	
Plate size (A,B)	140 x 110 mm
Bolt hole Ø (d)	11 mm
Bolt hole spacing (a,b)	105 x 75-80 mm

Rolling resistance



Operating noise



Floor surface preservation



LK-ALEV 200K

Variants	
	Antistatic version
	With 'ideal-stop' brake
	With non-marking grey tyre
	With 'stop-top' brake