

EA986JK-4



EAN: 4047526579449

ID: 579441

, Heavy duty wheel with Blickle Softhane® polyurethane tread, with aluminium wheel centre

Bracket:

Made of heavy pressed steel, with double ball bearing in the swivel head, strong central kingpin, swivel head seals. The special Blickle dynamic riveting process of the swivel head results in minimal swivel head play and smooth rolling characteristics with an increased service life achieved by the work hardening of the ball race grooves. Bolted wheel axle. Zinc-plated, blue-passivated, Cr6-free.

Wheels:

Tyre & running tread: Made of high-quality, reaction-injected polyurethane-elastomer Blickle Softhane®, very high operational comfort through the especially thick, elastic tread, low-noise operation, low rolling resistance, very good floor preservation, very high abrasion resistance, high cut and tear propagation resistance, very good chemical connection with the wheel centre. Tread colour:green

Rim / wheel centre: Made of die-cast aluminium. Casted tread.

Variants:

mit Feststeller "stop-fix"

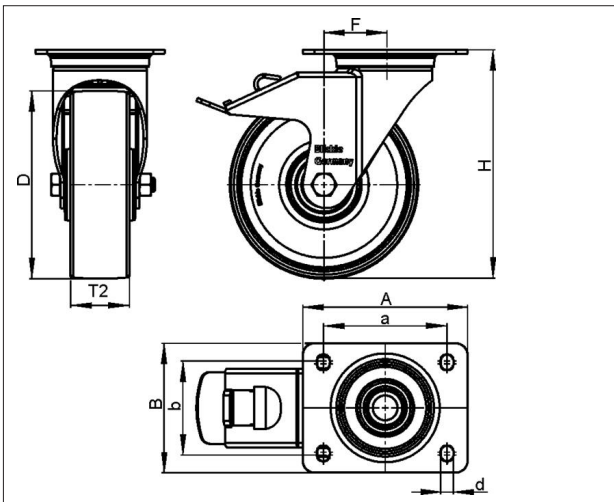

Technical data

| | |
|-------------------------|----------------|
| Wheel Ø (D) | 200 mm |
| Wheel width (T2) | 50 mm |
| Load capacity | 400 kg |
| Total height (H) | 235 mm |
| Offset swvl castor (F) | 65 mm |
| Unit weight | 3.8 kg |
| Temperature range from | -25 °C |
| Temperature range to | 70 °C |
| Tread & tyre hardness | 75° Shore A |
| Bearing type | |
| Plate size (A,B) | 140 x 110 mm |
| Bolt hole Ø (d) | 11 mm |
| Bolt hole spacing (a,b) | 105 x 75-80 mm |

Rolling resistance



Operating noise



Floor surface preservation



Blickle Räder+Rollen GmbH u. Co. KG

Heinrich-Blickle-Straße 1 · 72348 Rosenfeld · Germany

Telefon: +49 7428 932-0 · Telefax: +49 7428 932-209

E-Mail: info@blickle.com · Internet: www.blickle.com

© Blickle Räder+Rollen GmbH u. Co. KG 2013
Rosenfeld · Germany