

## EA986KJ-200



**EAN: 4047526266110**

**ID: 266114**

**Welded steel heavy duty swivel castor, Heavy duty wheel with Blickle Extrathane® polyurethane tread, with aluminium wheel centre**

**Bracket:**

Sturdy welded steel construction, with double ball bearing in the swivel head, additionally reinforced by the integration of four specially shaped and hardened bearing seats, swivel head seal with labyrinth design, fitted grease nipple, bolted and secured with a welded very strong central kingpin. Bolted wheel axle. Zinc-plated, blue-passivated, Cr6-free.

**Wheels:**

**Tyre & running tread:** Made of high-quality, reaction-injected polyurethane-elastomer Blickle Extrathane®, low-noise operation, low rolling resistance, good floor preservation, very high abrasion resistance, high cut and tear propagation resistance, very good chemical connection with the wheel centre. Tread colour: light brown

**Rim / wheel centre:** Made of die-cast aluminium. Casted tread.

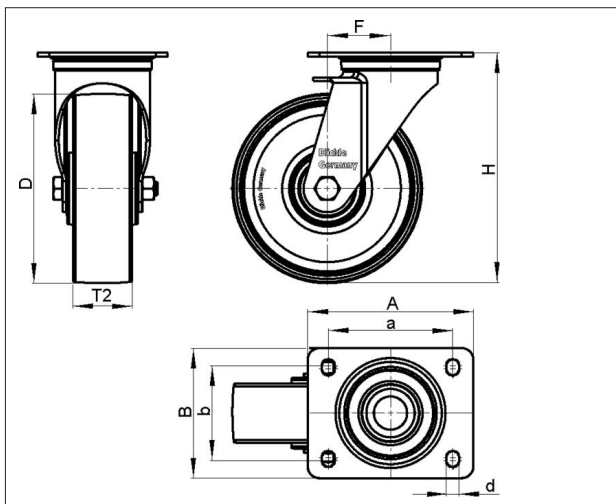

### Technical data

Wheel Ø (D)	200 mm
Wheel width (T2)	50 mm
Load capacity	800 kg
Total height (H)	245 mm
Offset swvl castor (F)	60 mm
Unit weight	4.618 kg
Temperature range from	-25 °C
Temperature range to	70 °C
Tread & tyre hardness	92° Shore A
Bearing type	
Plate size (A,B)	140 x 110 mm
Bolt hole Ø (d)	11 mm
Bolt hole spacing (a,b)	105 x 75-80 mm

Rolling resistance



Operating noise



Floor surface preservation



## LO-ALTH 200K

Variants	
	Antistatic version, non-marking grey
	With directional lock 2 x 180°
	With directional lock 4 x 90°
	With 'stop-top' brake