

EA986KR-250



EAN: 4047526097387

ID: 97386

Welded steel heavy duty swivel castor, strong swivel head design, Heavy duty wheel with Blickle Extrathane® polyurethane tread, with cast iron wheel centre

Bracket:

Particularly rugged welded steel construction, with axial grooved ball bearing DIN 711 and tapered roller bearing DIN 720 in the swivel head, dust and splash-proof, fitted grease nipple, bolted and secured with a welded very strong central kingpin. Bolted wheel axle. Zinc-plated, yellow-passivated, Cr6-free.

Wheels:

Tyre & running tread: Made of high-quality, reaction-injected polyurethane-elastomer Blickle Extrathane®, low-noise operation, low rolling resistance, good floor preservation, very high abrasion resistance, high cut and tear propagation resistance, very good chemical connection with the wheel centre. Tread colour: light brown

Rim / wheel centre: Made of grey cast iron, lacquered. Casted tread.

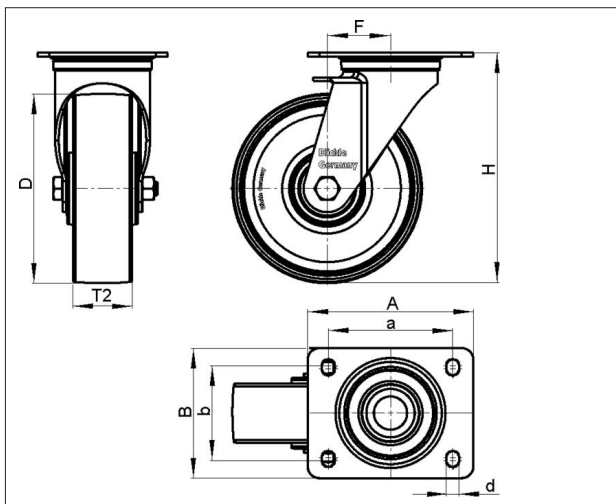

Technical data

Wheel Ø (D)	250 mm
Wheel width (T2)	80 mm
Load capacity	1800 kg
Total height (H)	305 mm
Offset swvl castor (F)	75 mm
Unit weight	16.45 kg
Temperature range from	-25 °C
Temperature range to	70 °C
Tread & tyre hardness	92° Shore A
Bearing type	
Plate size (A,B)	175 x 140 mm
Bolt hole Ø (d)	14 mm
Bolt hole spacing (a,b)	140 x 105 mm

Rolling resistance





Operating noise



Floor surface preservation



LS-GTH 252K

Variants	
	With directional lock 2 x 180°
	With directional lock 4 x 90°
	With 'stop-top' brake