

EA986LE-200



EAN: 4047526546458

ID: 546457

Stainless steel swivel castor with top plate fitting and 'stop-fix' brake, Wheel with thermoplastic polyurethane tread, with heavy nylon wheel centre

Bracket:

Made of pressed high-quality, chromium-nickel stainless steel (Material No. 1.4301/AISI 304), with double ball bearing in the swivel head, swivel head seals. The special Blickle dynamic riveting process of the swivel head results in minimal swivel head play and smooth rolling characteristics with an increased service life achieved by the work hardening of the ball race grooves. All parts incl. axle material are corrosion-resistant. Bolted wheel axle. Vibration-ground finished.

Wheels:

Tyre & running tread: Made of high-quality thermoplastic polyurethane, high operational comfort, low-noise operation, low rolling and swivelling resistance, good floor preservation, very high abrasion resistance, chemically bonded for an inseparable connection to the wheel centre. Tread colour: dark grey

Rim / wheel centre: Made of high-quality, impact-resistant nylon.

Variants:

mit Feststeller "stop-fix"

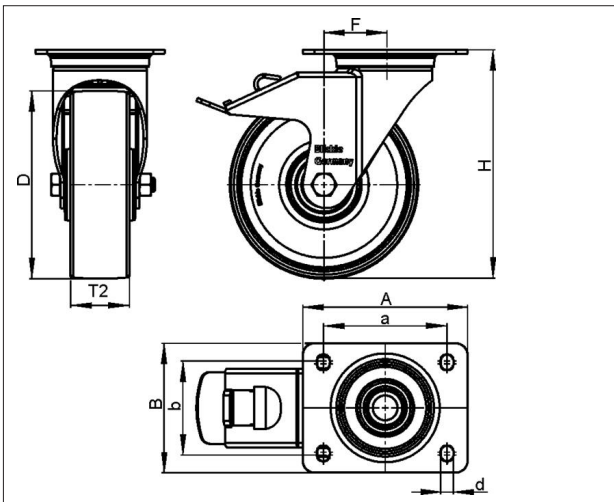

Technical data

Wheel Ø (D)	200 mm
Wheel width (T2)	50 mm
Load capacity	300 kg
Total height (H)	235 mm
Offset swvl castor (F)	54 mm
Unit weight	2.534 kg
Temperature range from	-25 °C
Temperature range to	70 °C
Tread & tyre hardness	94° Shore A
Bearing type	
Plate size (A,B)	140 x 110 mm
Bolt hole Ø (d)	11 mm
Bolt hole spacing (a,b)	105 x 75-80 mm

Rolling resistance



Operating noise



Floor surface preservation

