

## EA986LK-125



EAN: 4047526617493

ID: 617498

**Heat-resistant stainless steel swivel castor with top plate fitting, Heat-resistant Blickle TempLine® Classic thermoset wheel**

**Bracket:**

Made of pressed high-quality, chromium-nickel stainless steel (Material No. 1.4301/AISI 304), with double ball bearing in the swivel head, strong central kingpin. The special Blickle dynamic riveting process of the swivel head results in smooth rolling characteristics, increased service life and the swivel head play is set specifically for high temperature applications, with special heat-resistant grease. All parts such as balls, central kingpin and axle material are corrosion-resistant. Bolted wheel axle. Vibration-ground finished.

**Wheels:**

**Tyre & running tread:** Made of phenolic resin, very high static load capacity, smooth running performance on even floors. Tread colour: black

**Rim / wheel centre:** -

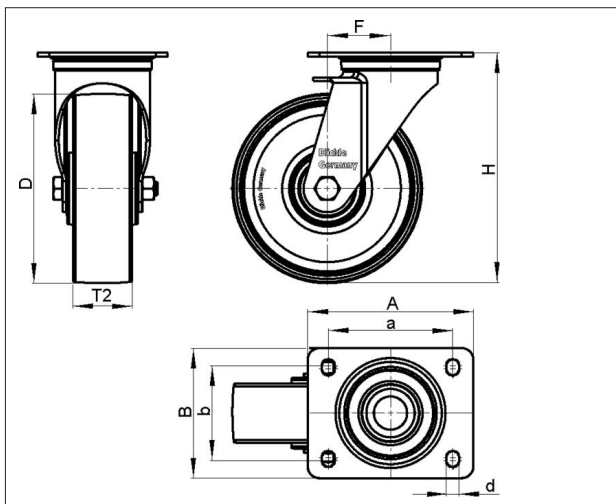

## Technical data

Wheel Ø (D)	125 mm
Wheel width (T2)	40 mm
Load capacity	150 kg
Total height (H)	150 mm
Offset swvl castor (F)	40 mm
Unit weight	0.95 kg
Temperature range from	-35 °C
Temperature range to	300 °C
Tread & tyre hardness	90° Shore D
Bearing type	
Plate size (A,B)	100 x 85 mm
Bolt hole Ø (d)	9 mm
Bolt hole spacing (a,b)	80 x 60 mm

Rolling resistance

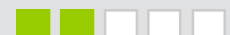

Operating noise



Floor surface preservation

