

EA986MX-310



EAN: 4047526257453

ID: 257451

Heavy duty wheel with pneumatic tyres

Tyre & running tread: Pneumatic tyre with tube, outstandingly high operational comfort, exceptionally high floor preservation, PAH conform acc. to EU directive 2005/69/EC. Tread colour: black

Rim / wheel centre: Pressed steel rim, pressed and bolted, with welded tubular steel hub, zinc-plated, blue-passivated, Cr6-free.

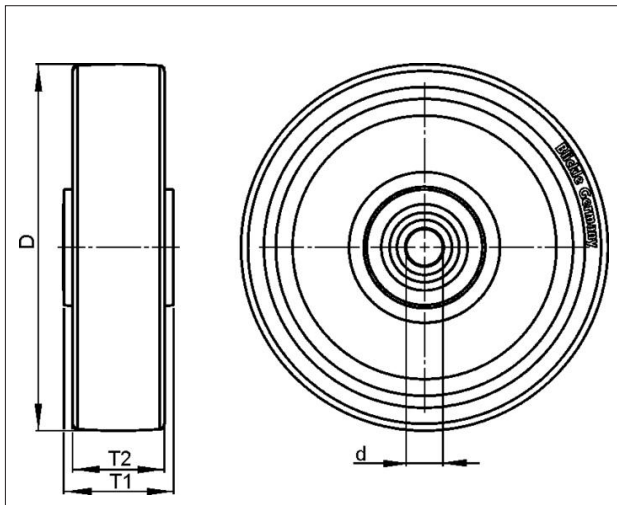

Technical data

Wheel Ø (D)	300 mm
Wheel width (T2)	100 mm
Tyre dimension	4.00-4
Ply-Rating	6
Profile	B02
Load cap. with 4 km/h	450 kg
Load cap. with 25 km/h	350 kg
Tyre pressure	7,5/110 bar/psi
Axle bore Ø (d)	25 mm
Hub length (T1)	75 mm
Unit weight	3.31 kg
Temperature range from	-25 °C
Temperature range to	50 °C
Tread & tyre hardness	65° Shore A
Bearing type	

Rolling resistance



Operating noise



Floor surface preservation

