

FURNITURE CASTORS

Twin Wheel Castor

SR 1547

Black Nylon

- Spark eroded finish
- Easy glide action
- Choice of mounting stems
- A choice of fittings below



Unhooded

Hooded

40mm Braked

50mm - hooded Braked

| Part Number | Dimensions (mm) | | | Max Static Load Bearing (kg) |
|-----------------------|-----------------|--------|--------|------------------------------|
| | Wheel Dia. | Hooded | Braked | |
| 500300 | 32 | Yes | No | 30 |
| 500301 | 40 | No | No | 50 |
| 500302 (EA986PC-140) | 40 | Yes | No | 44 |
| 500303 (EA986PC-140B) | 40 | Yes | Yes | 44 |
| 500304 | 40 | Yes | No | 50 |
| 500305 | 40 | Yes | Yes | 50 |
| 500306 (EA986PC-150) | 50 | Yes | No | 60 |
| 500307 (EA986PC-150B) | 50 | Yes | Yes | 60 |
| 500308 | 50 | Yes | No | 80 |
| 500309 | 50 | Yes | Yes | 80 |



Type 1
Gripneck Stem

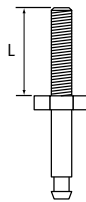

Type 2
Threaded Stem

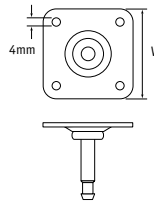

Type 3
Plate Fixing

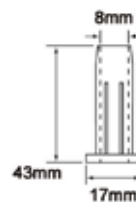

Type 4
Plastic Socket for
Gripneck Stem

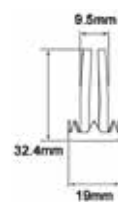

Type 5
Metal Socket for
Gripneck Stem

Castor fittings

| Part Number | Use with | Type | Dimensions (mm) |
|---------------------|---------------------------|------|-----------------|
| 500320 (EA986PC-7) | 32mm, 40mm - hooded | 1 | 38 (L) |
| 500319 (EA986PC-6) | 32mm, 40mm - hooded | 2 | M8x15 (L) |
| 500321 (EA986PC-9) | 32mm, 40mm - hooded | 2 | M8x25 (L) |
| 1287093 (EA986PC-8) | 32mm, 40mm - hooded | 3 | 35x35 (W) |
| 500316 | 32mm, 40mm, 50mm - hooded | 4 | - |
| 500324 | 40mm - unhooded | 1 | 38 (L) |
| 500322 | 40mm - unhooded | 2 | M8x15 (L) |
| 500325 | 40mm - unhooded | 2 | M8x25 (L) |
| 500323 | 40mm - unhooded | 3 | 35x35 (W) |
| 500312 (EA986PC-26) | 50mm - hooded | 1 | 38 (L) |
| 500310 (EA986PC-21) | 50mm - hooded | 2 | M8x15 (L) |
| 500313 | 50mm - hooded | 2 | M8x25 (L) |
| 500314 (EA986PC-22) | 50mm - hooded | 2 | M10x15 (L) |
| 500315 (EA986PC-23) | 50mm - hooded | 2 | M10x25 (L) |
| 500311 (EA986PC-25) | 50mm - hooded | 3 | 38x38 (L) |
| 500317 | 50mm - hooded | 5 | - |

The weight loadings quoted in this catalogue are for guide purposes only and assume that castors are used in a normal operating environment with floors in a smooth and reasonable condition.

Uneven or irregular floors will cause increased shock loadings. Castors of higher load-bearing capacity must be specified in these situations.

Castor loading capacity can be seriously impaired if castors are misused or poorly maintained, e.g. if used outside normal operating temperatures and/or if used in caustic environments.