

EA986SC-200



EAN: 4047526608279

ID: 608273

Extra heavy duty solid steel wheel

Tyre & running tread: Made of mild steel, with slightly crowned tread and lightly oiled surface, very low rolling and swivelling resistance, smooth running performance on even floors, extremely wear-resistant, particularly high static and dynamic load capacity. Tread colour: silver

Rim / wheel centre: -

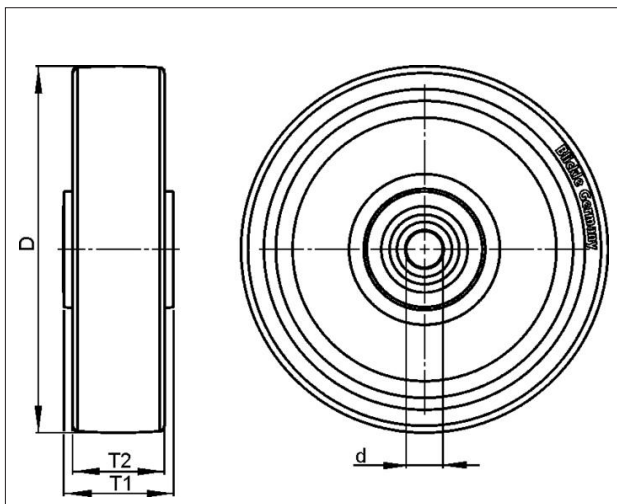

Technical data

Wheel Ø (D)	200 mm
Wheel width (T2)	55 mm
Load capacity	6000 kg
Axle bore Ø (d)	50 mm
Hub length (T1)	60 mm
Unit weight	11.75 kg
Temperature range from	-25 °C
Temperature range to	120 °C
Tread & tyre hardness	190 - 230 HB
Bearing type	

Rolling resistance



Operating noise



Floor surface preservation

