

# EA986SD-200



**EAN: 4047526008598**

**ID: 8599**

**Cast iron flanged wheel**

**Tyre & running tread:** Made of rugged grey cast iron, with grease nipple, machined tread with horizontal taper of 3°, exceptionally low rolling resistance, outstanding wear resistance, lacquered. Tread colour: silver  
**Rim / wheel centre:** -

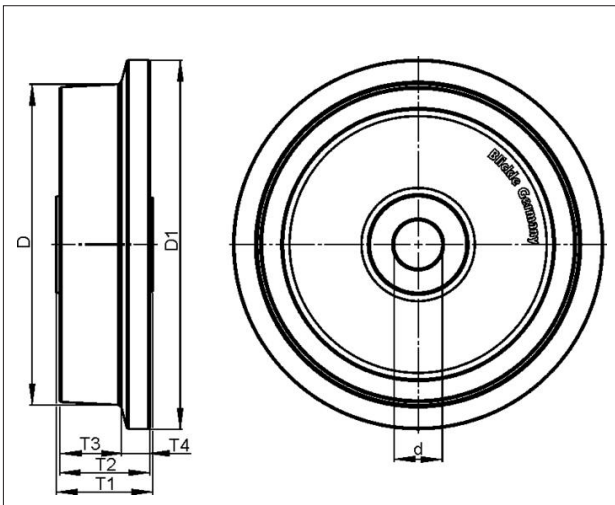

### Technical data

Wheel Ø (D)	200 mm
Wheel Ø incl. flange (D1)	230 mm
Wheel width (T2)	53 mm
Tread width without flange (T3)	38 mm
Flange length (T4)	20 mm
Load capacity	1500 kg
Axle bore Ø (d)	25 mm
Hub length (T1)	60 mm
Unit weight	7.54 kg
Temperature range from	-25 °C
Temperature range to	125 °C
Tread & tyre hardness	180 - 220 HB
Bearing type	

Rolling resistance



Operating noise



Floor surface preservation



**Blickle Räder+Rollen GmbH u. Co. KG**

Heinrich-Blickle-Straße 1 · 72348 Rosenfeld · Germany  
 Telefon: +49 7428 932-0 · Telefax: +49 7428 932-209  
 E-Mail: info@blickle.com · Internet: www.blickle.com

© Blickle Räder+Rollen GmbH u. Co. KG 2013  
 Rosenfeld · Germany