

EA986SD-250



EAN: 4047526008628

ID: 8623

Cast iron flanged wheel

Tyre & running tread: Made of rugged grey cast iron, with grease nipple, machined tread with horizontal taper of 3°, exceptionally low rolling resistance, outstanding wear resistance, lacquered. Tread colour: silver
Rim / wheel centre: -

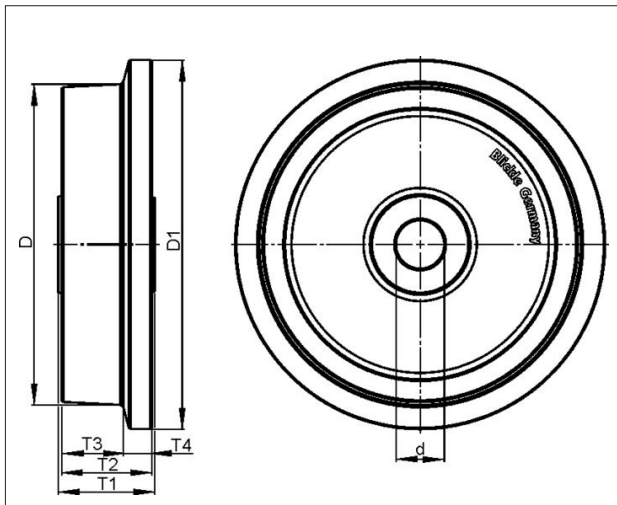

Technical data

Wheel Ø (D)	250 mm
Wheel Ø incl. flange (D1)	300 mm
Wheel width (T2)	65 mm
Tread width without flange (T3)	50 mm
Flange length (T4)	17,5 mm
Load capacity	2500 kg
Axle bore Ø (d)	30 mm
Hub length (T1)	70 mm
Unit weight	13.54 kg
Temperature range from	-25 °C
Temperature range to	120 °C
Tread & tyre hardness	180 - 220 HB
Bearing type	

Rolling resistance



Operating noise



Floor surface preservation

