

# EA986SD-75



EAN: 4047526008444

ID: 8441

Cast iron flanged wheel

**Tyre & running tread:** Made of rugged grey cast iron, with grease nipple, machined tread with horizontal taper of 3°, exceptionally low rolling resistance, outstanding wear resistance, lacquered. Tread colour: silver  
**Rim / wheel centre:** -

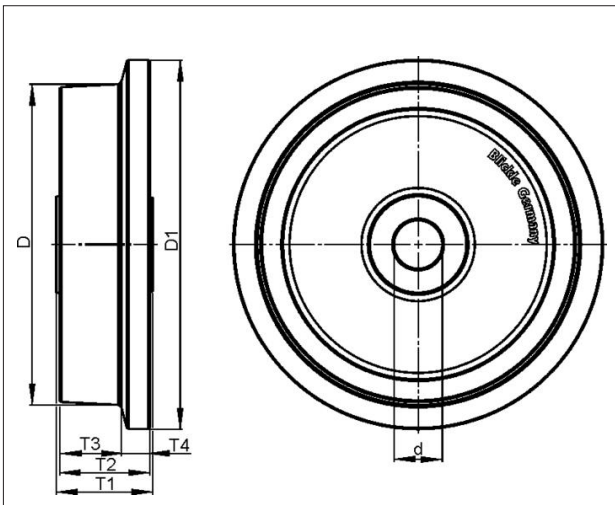

## Technical data

Wheel Ø (D)	75 mm
Wheel Ø incl. flange (D1)	100 mm
Wheel width (T2)	40 mm
Tread width without flange (T3)	30 mm
Flange length (T4)	13,5 mm
Load capacity	700 kg
Axle bore Ø (d)	20 mm
Hub length (T1)	47 mm
Unit weight	1.328 kg
Temperature range from	-25 °C
Temperature range to	120 °C
Tread & tyre hardness	180 - 220 HB
Bearing type	

Rolling resistance



Operating noise



Floor surface preservation



**Blickle Räder+Rollen GmbH u. Co. KG**

Heinrich-Blickle-Straße 1 · 72348 Rosenfeld · Germany  
 Telefon: +49 7428 932-0 · Telefax: +49 7428 932-209  
 E-Mail: info@blickle.com · Internet: www.blickle.com

© Blickle Räder+Rollen GmbH u. Co. KG 2013  
 Rosenfeld · Germany