

# TRAILER COUPLER

304 STAINLESS STEEL



Import



Stamped



Suncor  
Exclusive

EA987FN-21

EA987FN-22

EA987FN-23

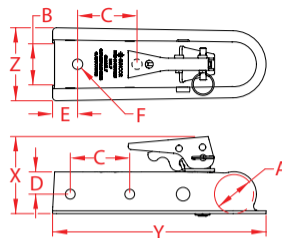

ITEM	A (ball size)	B	C	D	E	F	TOWING CAPACITY (lb)	X (height)	Y (length)	Z (width)	WT (lb)	PACKAGING TYPE	EACH (qty)	INNER (qty)	CARTON (qty)	UPC
C0265-4750	1-7/8"	2"	2.50"	1.19"	0.53"	0.41"	2,000	3.65"	9.00"	3.25"	2.73	POLYBAG	1	1	15	791506265405
C0265-4765	1-7/8"	2.5"	2.80"	1.20"	0.55"	0.38"	2,000	3.70"	9.00"	3.71"	2.45	POLYBAG	1	1	15	791506265108
C0265-5050	2"	2"	3.06"	1.00"	0.91"	0.50"	3,500	4.09"	11.00"	3.75"	4.22	POLYBAG	1	1	5	791506265504
C0265-5075	2"	3"	3.06"	1.00"	1.70"	0.53"	3,500	4.00"	11.13"	4.63"	4.57	POLYBAG	1	1	5	791506265306

**NOTE:**

**PRECISION FORMED, SOLID 304. QUALITY LATCHING MECHANISM FEATURES A HEAVY DUTY SAFETY LATCH TO HELP PREVENT ACCIDENTAL UNCOUPLING AND A PADLOCK HOLE WITH PROVIDED "QUICK PIN" FOR TRAILER SECURITY. USES 1/2" X 3" BOLTS. TOWING CAPACITY AND SIZE ARE PERMANENTLY MARKED ON TOP. CAUTION: CHECK NUT ON COUPLER BOTTOM AND TIGHTEN BEFORE USE. ALL DIMENSIONS ARE NOMINAL (+/- 3%) AND ARE SUBJECT TO CHANGE WITHOUT NOTICE.**